

**TESA**

**ASSA ABLOY**  
Made in Spain

MULTIPOINT SECURITY  
ACCESSORIES  
SECURITY MORTISE  
MORTISE LOCK  
NARROW MORTISE  
NARROW ESCUTCHEON  
CYLINDERS  
ACCESS CONTROL  
DIGITAL LOCK  
DOOR CLOSER  
PANIC EXIT DEVICES  
HANDLESET  
KNOBSETS  
DEADBOLTS  
PADLOCKS  
MASTER KEY SYSTEM  
ACCESSORIES



TESA

ASSA ABLOY  
Made in Spain

# MULTIPOINT SECURITY

## The future generation of security locks



With the launch of the **TLP** range of multipoint locks for levers, **TESA** created in the 80's the template for future security locks. Since then, there have been multiple innovations such as antisaw locking bolts, corner piece locks, antidrill escutcheons, improving what already was one of the most complete ranges in the European security market. But things have changed and now it's time to take another quantum leap towards big-time security with the **PLUS** and **PREMIUM** ranges.

## TESA concept for global security



High and low locking points in carbonitrided steel. Carbonitride is a surface treatment that provides extraordinary hardness.



RB03 hinge reinforcements: antisaw and antilever protection



Auxiliary locking points reinforced with a patented no-return system.



Central case with a reinforced device. Optional follower rod and steel latch for RF doors. Also available: PANIC exit device in TLBA, R20AB and TCBA series.



Security escutcheon, anti-extraction and antidrill protection. Tempered steel protection plate in the E700 escutcheon. Tempering provides the inner structure of the material with high antidrill hardness.



Floor strike with antidust protection.

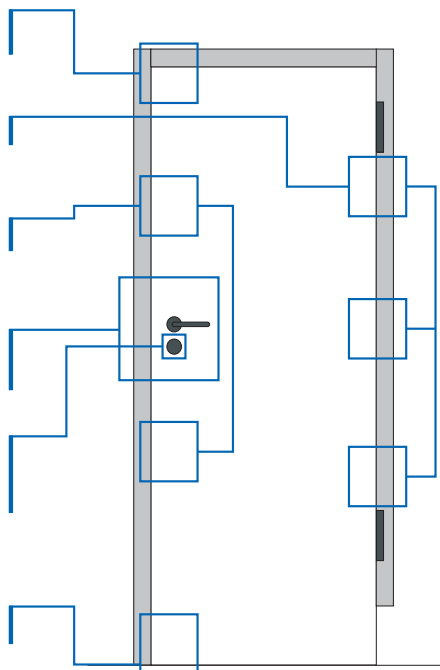

## TLB Series

TLB35SCAI  
(ROLLER)

TLB55SCAI  
(ROLLER)

TLB36SCAI  
(LATCH)

TLB56SCAI  
(LATCH)



TLB35SCCE  
(ROLLER)

TLB55SCCE  
(ROLLER)

TLB36SCCE  
(LATCH)

TLB56SCCE  
(LATCH)

### SPECIFICATIONS:

- Circular roller bolts in the main lock. (Ø14mm. diameter).
- Plane edge roller bolts in auxiliary locks.
- Mechanisms protected in galvanised steel closed cases.
- Floor & Top Jamb locking bolts in hardened steel (TLB5).
- Steel made Floor & Top Jamb strikes. Floor strike includes dust proof lid.
- "U" profile steel faceplate provides great strength and is ideal for Fire Doors.
- Auxiliary locks mechanisms provided with anti-return system.
- Standard height is 2030mm (minimum height 1875). 2300mm height is also available.
- Standard faceplate has a 20x10mm. profile.
- Included escutcheon E700L.

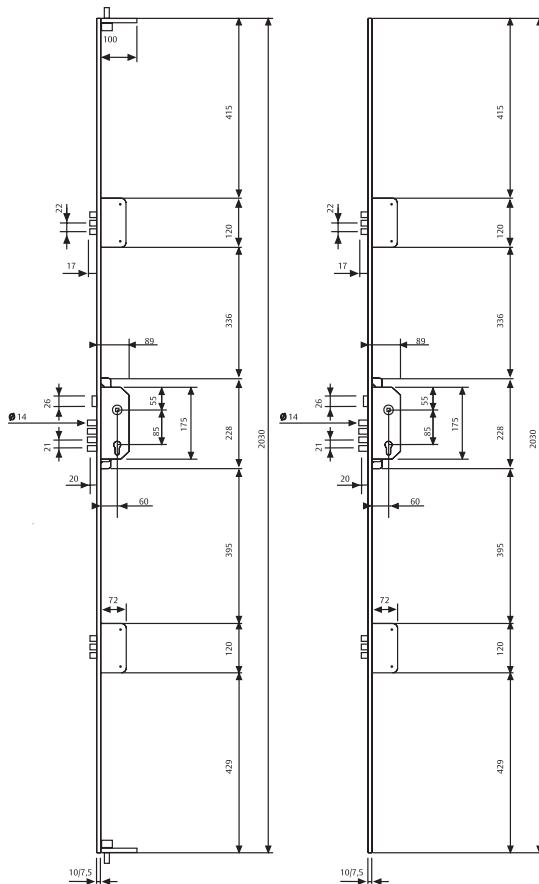

### Item

#### 3-Point Multipoint (2300mm)

TSB35SC/XX2300 (Latch)  
50X85 - Short

#### 5-Point Multipoint (2300mm)

TSB55SC/XX2300 (Latch)  
50X85 - Short  
TSB56SC/XX2300 (Latch)  
60X85 - Short

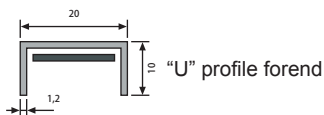

TESA

ASSA ABLOY  
Made in Spain

# MULTIPOINT SECURITY

## TLPN Series

### SPECIFICATIONS:

- Carbonitrided steel antilever hooks in auxiliary cases.
- High and low locking points in carbonitrided steel.
- High steel strike and floor strike with antidust protection.
- All devices are protected by closed galvanized steel cases.
- Highly rigid U-type profile steel front. Ideal for RF doors.
- Auxiliary locks mechanisms provided with anti-return system.
- Standard height is 2030mm (minimum height 1875).
- 2300mm height is also available.
- Standard faceplate has a 20x10mm. profile.
- Included escutcheon E700L.

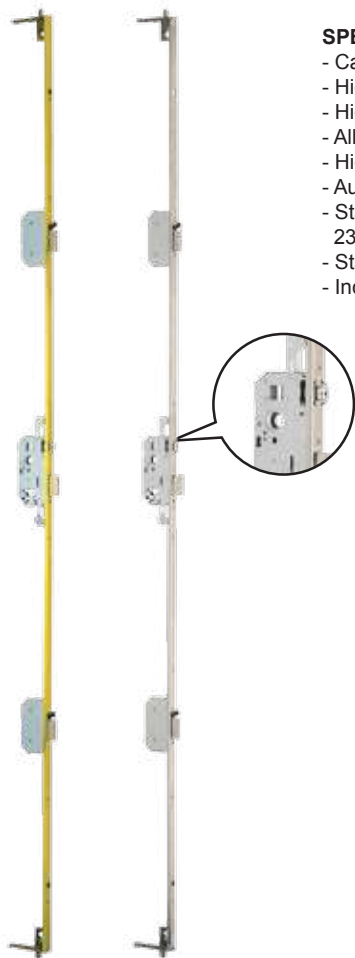

TLPN56SCCE  
(ROLLER)

TLPN56SCCN  
(ROLLER)

TLPN56SCCE  
(ROLLER) / 2300mm

TLPN56SCCN  
(ROLLER) / 2300mm

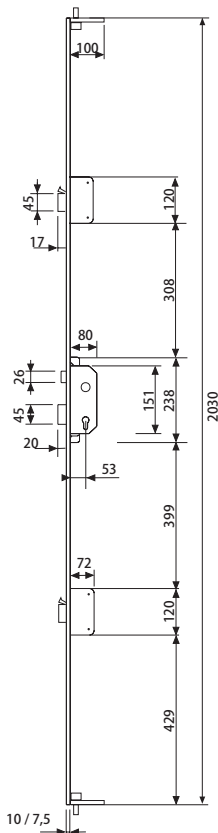
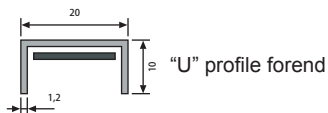

## Face plate

Face plate extensions SPTL10 and SPTL28 allow extending the face plate length up to any door size with mortise multipoint locks without top jamb locking bolt. Using the STLP61LP top jamb locking bolt rod extension allows reaching 2.460mm. in the TLB5 and TLPN5 models.



STLP61LP  
Top jamb locking bolt rod extension.

SPTL28AC - 280MM  
SPTL28AE - 280MM  
SPLP61LP  
SPTL10AC - 100MM  
SPTL10AE - 100MM



SPTL10 SPTL28

Description	Code No.	Finish
100 mm. face plate extensions	SPTL10AE	AE
100 mm. face plate extensions	SPTL10HN	HN
280 mm. face plate extensions	SPTL28AE	AE
280 mm. face plate extensions	SPTL28HN	HN
TLB5, TLPN5 face plate extensions	STLP61LP	LP

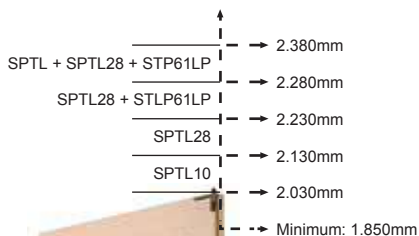
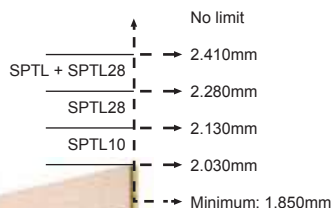

## RB03-Hinge reinforcement bolts

The RB03 set consists of three pairs of solid steel bolts to be mortised both in the door leaf and frame at the hinged edge of the door. This provides greater protection against saw and crowbar attack. Installation drill bits is included.

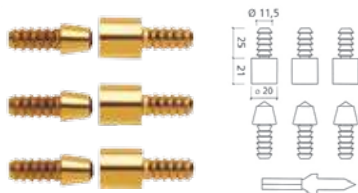

RB-03

## Dust Proof floor strike

- Floor strike for bottom locking in TLB5 and TLPN5 series locks.
- It possesses a spring-loaded protective lid that prevents dust from getting into the strike hole.
- Nickel plated finish.

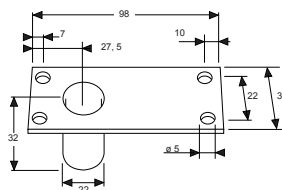

## R200B, R201B & R206B Series

### SPECIFICATIONS:

- Four roller bolts in nickel plated steel. Ø 14mm. diameter.
- Three roller bolts in R201B model.
- Mechanisms protected in zinc plated steel closed case in R200B model.
- R201B has open cases that included top and bottom protective lids.
- Models R201B & R206B included E700L security escutcheon.
- Solid brass faceplate and steel plated strike plate.
- Backset (XX): 50mm and 60mm.

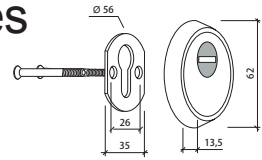

**OPTIONAL**  
Escutcheon E700L



R206B-XX-AI



R200B-XX-HN



R200B-XX-HL



R201B-XX-HN



R201B-XX-HL

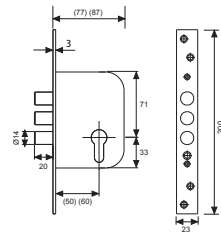
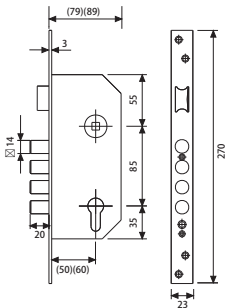

Code No.	Backset	Finish
R200B5SCL	50	LT
R200B5SCN	50	LN
R200B6SCL	60	LT
R200B6SCN	60	LN
R206B5SAI	50	AI
R206B5SHE	50	HE
R206B6SAI	60	AI
R206B6SHE	60	HE

Code No.	Backset	Finish
R201B5SCL	50	LT
R201B5SCN	50	LN
R201B6SCL	60	LT
R201B6SCN	60	LN

## R400B Series

### SPECIFICATIONS:

- Four roller bolts in nickel plated steel. Ø 14mm. diameter.
- Mechanisms protected in zinc plated steel closed case.
- Solid brass faceplate and steel plated strike plate.
- Backset: 70mm.



R400B-70-LN



R400B-70-LT

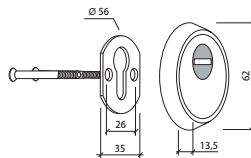

**OPTIONAL**  
Escutcheon E700L

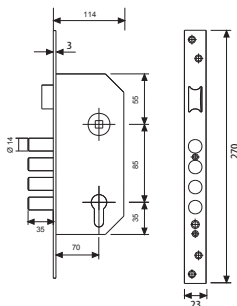

Code No.	Backset	Finish
R400B7SCL	70	LT
R400B7SCN	70	LN

# R200N & R201N Series

**SPECIFICATIONS:**

- Saw-resistant deadbolt reinforced with tempered steel plates and hardened steel security hook.
- Deadbolt throw: 20mm.
- Mechanisms protected in zinc plated steel closed case.
- R201N has open case that includes top and bottom protective lids.
- Models R201N included E700L security escutcheon.
- Solid brass faceplate and steel plated strike plate.
- Backset (XX): 50mm and 60mm.

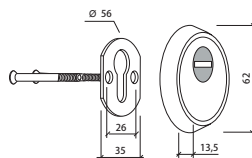

**OPTIONAL**  
Escutcheon E700L



R200N-XX-LN



R200N-XX-LT



R201N-XX-LN



R201N-XX-LT

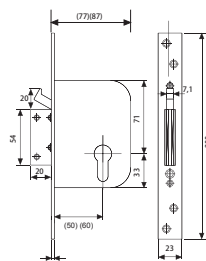
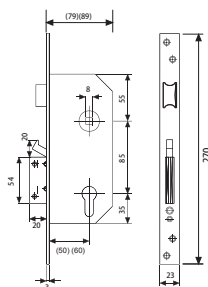

Code No.	Backset	Finish
R200N00SC	50	LT
R200N00SN	50	LN
R201N600SC	60	LT
R201N600SN	60	LN

Code No.	Backset	Finish
R201N00SC	50	LT
R201N00SN	50	LN
R201N600SC	60	LT
R201N600SN	60	LN



# SECURITY MORTISE



## R206N Series

### SPECIFICATIONS:

- Saw-resistant deadbolt reinforced with tempered steel plates and hardened steel security hook.
- Deadbolt throw: 20mm.
- Mechanisms protected in zinc plated steel closed case.
- E700L security escutcheon. Anti-drill and anti-extraction attack.
- Solid brass faceplate and steel plated strike plate.
- Backset (XX): 50mm and 60mm.

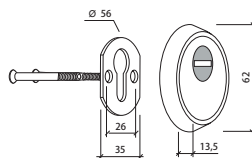

Included escutcheon E700L



R206N-XX-LN



R206N-XX-LT

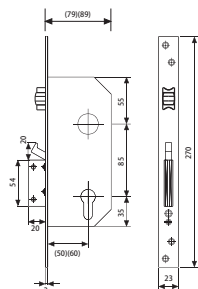

Code No.	Backset	Finish
R206N00SC	50	LT
R206N00SN	50	LN
R206N600SC	60	LT
R206N600SN	60	LN

## Accessories

Finish TCBA	R206N / R200N / R201N		R200B / R201B	
Face Plate	LT	LN	LT	LN
Strike	HL	HN	HL	HN
Lock Case	Galvanised Steel		Galvanised Steel	
Security Escutcheon	E700L	E700L	E700L	E700L

Evolution in mortise locks has led TESA to expand its range constantly, with various backsets, finishes, distances between shafts, latch solutions, PEDs, locks for schools, hospitals, offices...

## A wide range

TESA offers a wide range of mortise locks with various solutions, backsets, distances between shafts, latch solutions, PEDs, automatic projections, functions...



## Finishes

A wide choice of finishes. Guaranteed by TESA, STAINLESS finishes ensure high anticorrosion resistance. Available finishes: painted, nickel, brass...



## UNE-EN 12209 certification

The locks in the institutional range have been certified by the European standard that regulates architectural fittings. This ensures that requisites of durability are met, as well as resistance, security and the right functioning of locks and latches.



## Guaranteed process

Our advanced I+D department is constantly working to improve production processes, providing the market with new, enhanced products that meet the increasingly demanding needs in the market. TESA manufactures all its products with top quality products such as stainless steel, which is employed as the standard material for fronts and strikes.



## Guaranteed by tesa

Buying TESA is a quality guarantee. All our products boast the highest guarantees, such as the ISO 9001 Quality certificate, the environmentally-conscious ISO 14001 and the Occupational Hazard Prevention standard. TESA offers ecologically sustainable quality products, manufactured by highly dedicated staff.



## Components of the lock

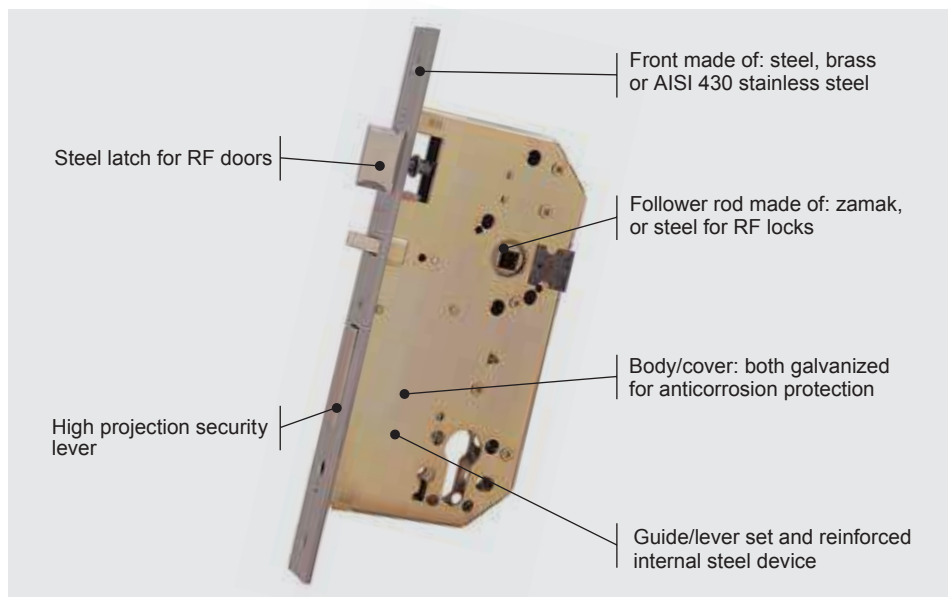

### Anticard security device

When we close the door without locking it with a lever, this device prevents the latch from being pushed in from the outside with a card or a radiography.

### Protective antidrill follower rod

It is used in panic exit locks with a double follower rod - this protects the door from attempts of drilling it from the outside and inserting a handle in order to open it.

### Finishes guarantee

Finishes		Layer hardness s/ANSI A 156.18	Adherence s/ASTM D 3359/90	Anticorrosion resistance s/prEN 1670
HL	Brass plated steel	4H	4B	up to 96 hours
HN	Nickel plated steel	4H	4B	up to 96 hours
HC / HE / AE	Glazed steel	4H	4B	up to 96 hours
AI	AISI 430 stainless	4H	4B	up to 96 hours

TESA

ASSA ABLOY  
Made in Spain

# MORTISE LOCK

## Standard mortise

### SPECIFICATIONS:

- Sashlock for timber doors.
- Reversible.
- Distance between axes: 85 mm.
- Backset (XX): 40/ 45/ 50/ 60/ 70 mm.
- Follower: 8 mm. Thumbturn follower: 6 mm.



4030-XX-AI 4030-XX-HE

Code No.	Backset	Finish
403040AI	40	AI
403050AI	50	AI
403060AI	60	AI
403070AI	70	AI
403040HE	40	HE
403050HE	50	HE
403060HE	60	HE
403070HE	70	HE



4010-5P-HN

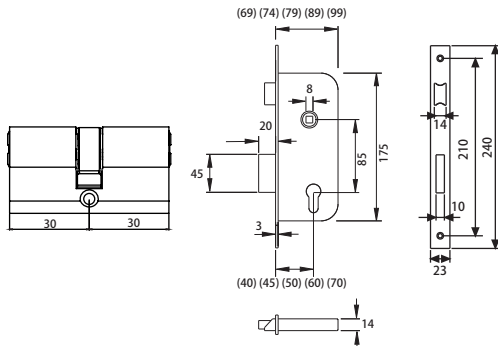
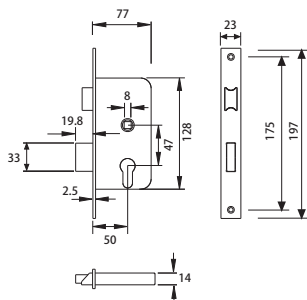

2030-40-HC 2030-45-HC

Included  
50303030N



2030-40-HE 2030-45-HE

Included  
50303030L

Code No.	Backset	Finish
203040HC	40	HC
203045HC	45	HC
203040HE	40	HE
203045HE	45	HE

# MORTISE LOCK

## Roller mortise

### SPECIFICATIONS:

- Deadbolt throw: 20mm.
- Backset (XX): 50/ 60mm.

Code No.	Backset	Finish
203650AI	50	AI
203660AI	60	AI
203650HL	50	HL
203660HL	60	HL

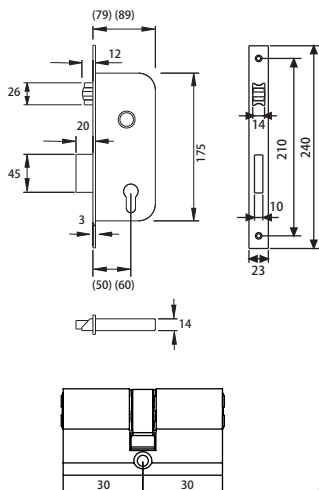

Included 50303030N



2036-XX-AI



2036-XX-HL



Included 50303030L

### ROLLER MORTISE OPERATING INSTRUCTION

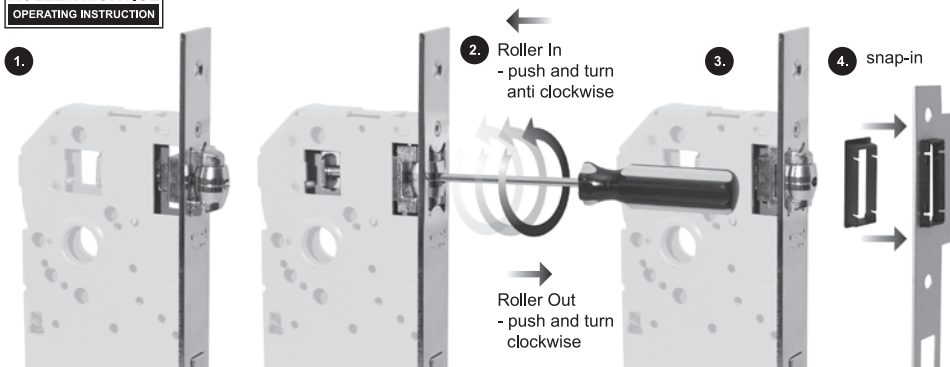

## Deadlatch & passage mortise

### SPECIFICATIONS:

- Deadbolt throw: 20mm.
- Backset (XX): 50 / 60mm.



Included  
50303030N



2031-XX-HN



2031-XX-HL



Included  
50303030L

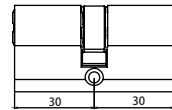
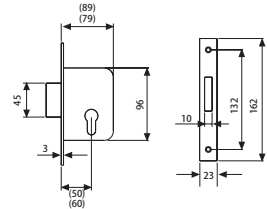

Code No.	Backset	Finish
203150HN	50	HN
203160HN	60	HN
203150HL	50	HL
203160HL	60	HL

### SPECIFICATIONS:

- Reversible latchbolt withdraws from either side with lever.
- Backset (XX): 40 / 50 / 60mm.



2015-XX-HN



2015-XX-HL

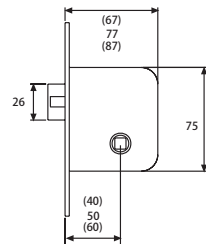

Code No.	Backset	Finish
201540HN	40	HN
201550HN	50	HN
201560HN	60	HN
201540HL	40	HL
201550HL	50	HL
201560HL	60	HL

# MORTISE LOCK



## Institutional range

### 2S30 Silence series

Hospitals, schools, office buildings, ... deal with intensive public traffic and rough use.

Locks included in the Commercial Range bring together reliability and functionality, and combine also with handles, panic bars, electro-magnetic devices, etc. provided by TESA.

#### Features

- Sashlock for timber doors.
- Reversible latchbolt.
- Distance between axes: 85 mm.
- Backsets: 60 mm.
- Follower: 8 mm.
- Closed lockcase.
- Euro-profile 5 pin cylinder made to DIN V 18254 with 3 nickel plated steel sawn keys. AI finish: nickel finished cylinder.

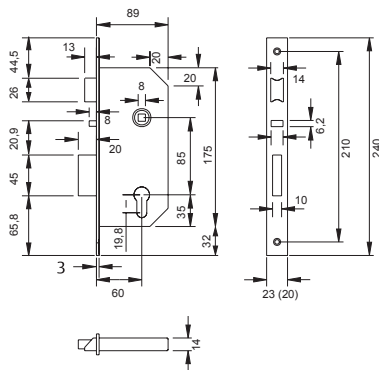

Code No.	Follower	Anticard system	Interior operation	Exterior operation	Latchbolt	Deadbolt	Fire resistance	Antipanic	Notes
2S30A	standard	YES	handle/cylinder	cylinder	YES	YES	NO	YES	Silence latchbolt.



CERTIFIED ACCORDING  
**UNE-EN  
12209:2004**

Code No.	Backset	Finish
2S30A60AI	60	AI

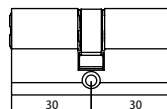

Included 50303030N

2S30A-60-AI

## Institutional range

### 2038 series

**Features:**

- Backsets: 60 mm.
- Activable hook with cylinder.
- Included double cylinder 5030-60-LT/LN



2038-60-AI



2038-60-HL

Included 50303030N

Included 50303030L

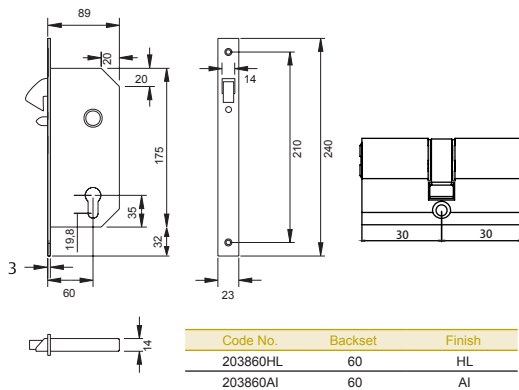

Code No.	Backset	Finish
203860HL	60	HL
203860AI	60	AI

### 203MN automatic series

**Features:**

- Distance between shafts: 85 mm.
- Backsets: 60 mm.
- 8 mm follower rod.
- Automatic lever projection.
- Panic exit function.
- Anticard device.
- Apt for firebreak doors.
- Extra security:
  - The lever is not projected until the latch is lodged in the frame.
  - The lever has double interlocking, halfway and at the end of the trajectory.
- Included half cylinder 5030-301-LN



203MN-60-AI

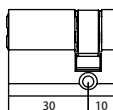

Included 50303010N

CERTIFIED ACCORDING  
**UNE-EN  
 12209:2004**

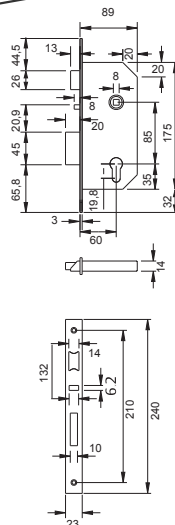

Code No.	Backset	Finish
203MN60AI	60	AI



# NARROW MORTISE



## Swinging Hook - 4240 Series

### SPECIFICATIONS:

- Faceplate and strike plate made in AISI 304 stainless steel.
- Solid steel reinforced hook.
- Nickel plated latch is reversible and can be retracted by handle or key.
- Two E-190 cylinder oval roses included.

E190 escutcheon



4241



4240



4246

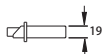
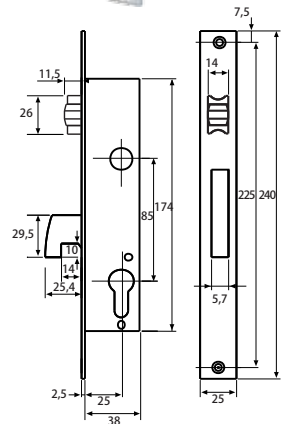
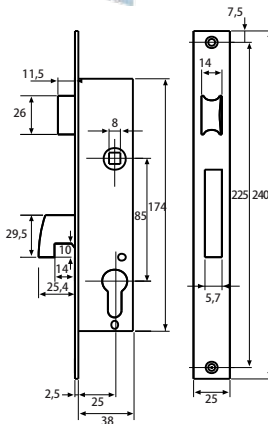
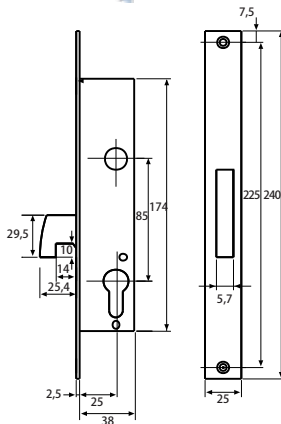

Code No.	Backset	Finish
4241255NM	25	SS
4240255NM	25	SS
4246255NM	25	SS

TESA

ASSA ABLOY  
Made in Spain

# NARROW MORTISE

## Swinging Deadbolt - 4210 Series

### SPECIFICATIONS:

- Faceplate and strike plate made in AISI 304 stainless steel.
- Nickel plated steel bolt with reinforced swinging mechanism.
- Bolt throw: 25mm.
- Two E-190 cylinder oval roses included.



E190 escutcheon



4210



4216

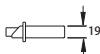
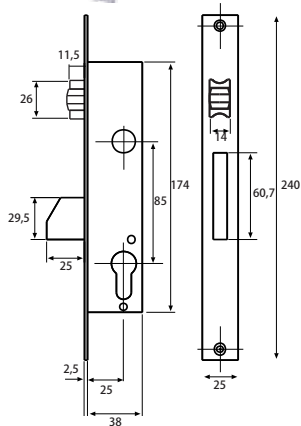
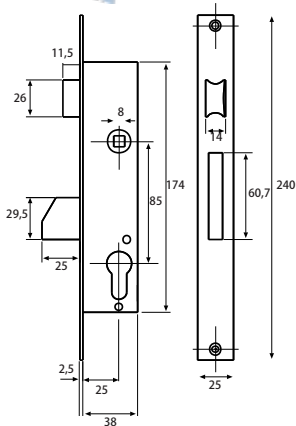

Code No.	Backset	Finish
4210255NM	25	SS
4216255NM	25	SS

# NARROW MORTISE



## 3 Locking point - reinforced hook 4230L Series

### SPECIFICATIONS:

- Faceplate and strike plates made in AISI 304 stainless steel.
- 3 locking points, two swinging bolts + reinforced hook.
- Two E-190 cylinder oval roses included.



4230 L

4236 L

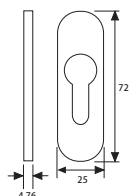
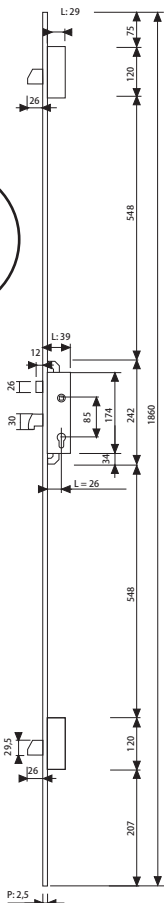

E190 escutcheon



Code No.	Backset	Finish
4230L25NM	25	SS



Code No.	Backset	Finish
4236L25NM	25	SS

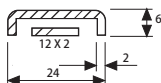

Frontplates detail

## Narrow mortise security escutcheon

### Security escutcheons E240

**Features:**

- The new cylinder escutcheon, the E240, offers design and security.
- 2 tempered plates protect the cylinder from direct attacks using drill, offering the same security level that the cylinder escutcheons used in Tesa security doors.

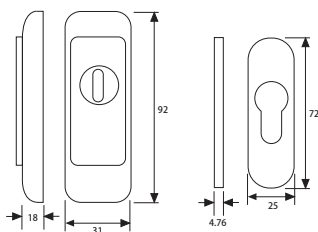

Code No.	Finish
E24000BL	BL
E24000NE	NE
E24000NS	NS

### Anti extraction attack E210

**Features:**

- Anti extraction attack cylinder rose manufactured in metallic alloy.
- Nickel plated steel plate in the interior is hidden with a snap-in polyamide cover
- Very easy installation with bolt through fixing with M5 screws.

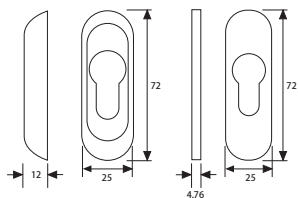

Code No.	Finish
E21000BL	BL
E21000NE	NE
E21000NM	NM

# CYLINDERS



Global leaders manufacturing cylinders



TESA cylinders are manufactured according to the most advanced production processes, offering an extremely secure high quality product and meeting the requirements of the market demands in every different area.

TESA's range of cylinders includes a great variety of profiles in every system. TESA also offers the possibility of combining mechanical cylinders with access control systems.

## Security

Ranging from the most basic to the highest security patented, restricted-key models, our cylinders have been equipped with the most advanced protection systems: spring loaded pins, antiremoval system, etc., as befits TESA's position as the first European cylinder manufacturer. Our restricted key systems guarantee that no blank keys will be found in the market, thus ensuring protection against counterfeit keys.



## A wide range

We have classified our systems according to four standards:

- Type of key (dimple or sawn)
- Restricted key
- Degree of security
- Masterkeying capacity

The combination of such standards has created a peerless range in the market, covering every requisite in projects ranging from the residential to the institutional, from cost-efficient technical systems to high security patented systems, offering the distributor maximum profitability.



## Masterkeying capacity

All TESA systems can be master keyed. A masterkeying is a planned locking system in which the master key can open more than one cylinder, even if each cylinder has its own key. For offices, residential homes and plants of various sizes, masterkeying is the immediate solution that allows to establish an access control while reducing the number of keys that must be handled: security and comfort.



## Guaranteed by TESA

TESA meets the most demanding European standards for architectural fittings, in which cylinders are very important components in terms of protection and personal safety. Specifically, the EN 1303 European standard establishes five degrees of security (fire resistance, security against breakage, number of combinations, durability and corrosion resistance) for cylinders, based on design requisites and on practice tests simulating an attack.

The DIN standard specifies which standards must be met by cylinders in order to obtain masterkeying certifications. Other standards and certifications met by TESA's cylinders are UL (USA), NEN (Holland) and SS (Sweden).

## Introduction

- » The terminology employed in order to specify the various components that form a cylinder.
- » Selection criteria. The facts we must bear in mind when prescribing a system.
- » Systems. In this part, we will define the features of each model.
- » Profiles and models for particular applications.
- » Masterkeyings. In which we show the most usual diagrams.

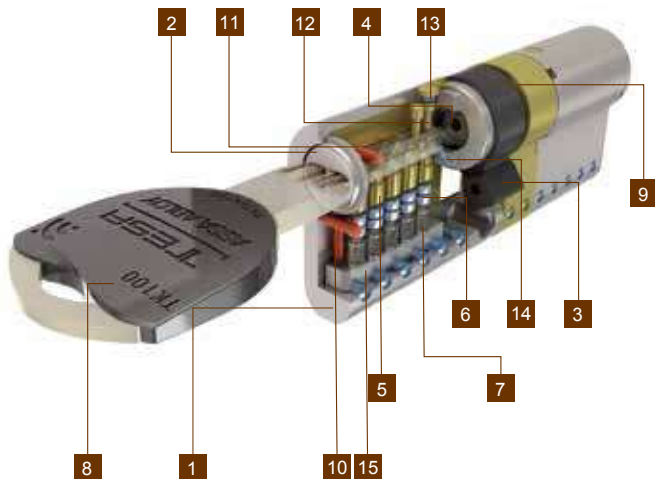

	Description
1	Barrel / Shell / Body. Frame which support the assembly.
2	Rotor / Plug. Is the part where the key is inserted to lock / unlock.
3	Cam. Translates the rotating motion of the key into sliding bolt projection.
4	Clutch. Is the component that connects one rotor, in a double cylinder, with the cam.
5	Lower pin (main row). Determines the permutation of the cylinder.
6	Upper pin (main row). Lower pin counterpart.
7	Springs. Load the pinning.
8	Key. Main accesory. Operates the cylinders.
9	Retaining clips. Fix the cylinder in a functional way.
10	Drill-proof body pin. Gives resistance against drilling and mechanical attacks
11	Drill-proof rotor pin. Gives resistance against drilling and mechanical attacks
12	Lower pin (sec.row). Same function as the main row.
13	Upper pin (sec.row). Same function as the main row.
14	Sensor. Part of the patent. Protects the cylinder against different opening methods.
15	Caps. Keep the pinning loaded

## Profiles

Double cylinder

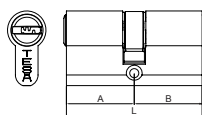

Half cylinder

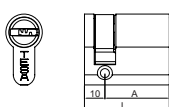

Single cylinder

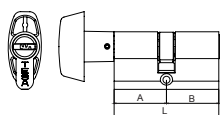

Adjustable european cylinder

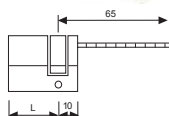

Rim lock cylinder

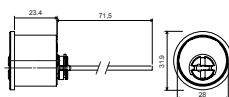

Screw in cylinder

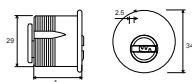

Knobsets cylinder

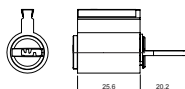

Deadbolt cylinder

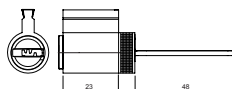

Padlocks

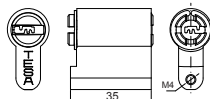

Cam lock

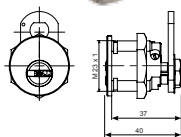



## Standard cylinder TE5

Technical data.

TE5 covers the basic segment of the range. Entirely manufactured and assembled in Spain is the most balanced solution for regular and master keyed installations.

Characteristics

- Type: Sawn key. (Steel nickel plated).
- NO. of rows: 1
- NO. of pins: 5
- Technology: Tumbler regular.
- Permutation level: Grade 5.
- Corrosion resistance: Grade B.
- Pick protection: Medium level.
- Lifespan: 50,000 test cycles.
- 3 keys per cylinder.
- Conform to EN-1303 regulation.

Options

- Finishes: Brass / Nickel plated.
- Cam: DIN R15 and R13
- Formats available: Key different, mater keyed, key alike and specific codes.
- Wide measurement and profile range.

Master key systems.

The platform which supports its manufacturing lets combine 10 heights per position. Thanks to that, the TE5 can face master key systems with total working guarantee. Capability graph (Average quantities)

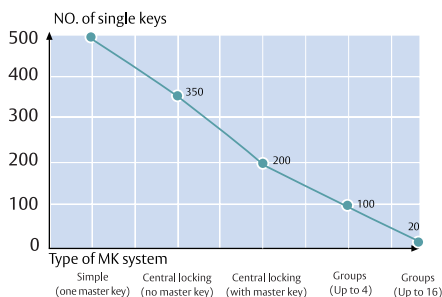

Security

\*

Masterkeying

\*



European standard regulation

In the same way as the main models included in the catalogue, TE5 is certified according to the European standard regulation.

1	5	0	1	0	B	2	0
Key resistance (Grade 0-1)	Lifespan (Grade 4-6)	Door mass (Not applied in cylinder)	Fire resistance (Grade 0-1)	Safety of the people (Not applied in cylinders)	Corrosion and temperature resistance (Grade 0-A-B-C)	Key related security (Grade 1 to 6)	Attack resistance (Grade 0 to 2)

Recommendations

- Use TESA lubricant to lengthen the maximum lifespan of the cylinder.
- Use original keys to make copies.
- For safety reasons, when you install a new cylinder, remember that once installed, it should not project more than 1mm.



TE5 Blister Pack

## Standard cylinder TE5

### European profile

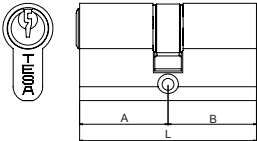
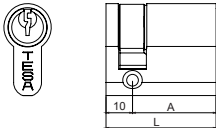
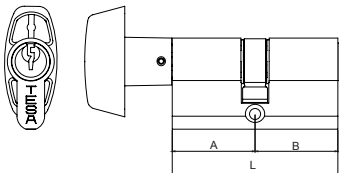
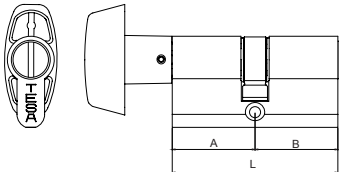
Double Cylinder		L	A	B	Cam = 15 mm	Finish	U/Price
		60	30	30	5030 30 30 L	Brass	
		70	35	35	5030 35 35 L	Brass	
		100	50	50	5030 50 50 L	Brass	
		60	30	30	5030 30 30 N	Nickel	
		70	35	35	5030 35 35 N	Nickel	
		100	50	50	5030 50 50 N	Nickel	
Half Cylinder		L	A	B	Cam = 15 mm	Finish	U/Price
		40	30	10	5030 30 10 L	Brass	
		45	35	10	5030 35 10 L	Brass	
		40	30	10	5030 30 10 N	Nickel	
		45	35	10	5030 35 10 N	Nickel	
Single Cylinder		L	A	B	Cam = 15 mm	Finish	U/Price
		60	30	30	503B 30 30 L	Brass	
		70	35	35	503B 35 35 L	Brass	
		60	30	30	503B 30 30 N	Nickel	
		70	35	35	503B 35 35 N	Nickel	
Privacy Cylinder		L	A	B	Cam = 15 mm	Finish	U/Price
		60	30	30	5034B 30 30 L	Brass	
		70	35	35	5034B 35 35 L	Brass	
		60	30	30	5034B 30 30 N	Nickel	
		70	35	35	5034B 35 35 N	Nickel	



Security cylinder T50

CYLINDER FEATURES



- Number of pins : 5 in one row
- Antipick cylinder
- Grade 5 in permutation (45,000 different codes)
- Lifespan : 100,000 cycles
- 3 keys per cylinder
- Conform to UNE-EN 1303
- Made in Spain

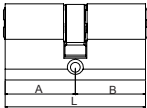

European profile

Double Cylinder	L	A	B	Cam = 15 mm	Finish	U/Price
	60	30	30	T503 30 30 L	Brass	
	70	35	35	T503 35 35 L	Brass	
	60	30	30	T503 30 30 N	Nickel	
	70	35	35	T503 35 35 N	Nickel	

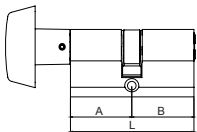
T503 30 30 N

Single Cylinder	L	A	B	Cam = 15 mm	Finish	U/Price
	60	30	30	T503B 30 30 L	Brass	
	70	35	35	T503B 35 35 L	Brass	
	60	30	30	T503B 30 30 N	Nickel	
	70	35	35	T503B 35 35 N	Nickel	

T503B 35 35 L



T50 Blister Pack

## Security cylinder T60

### Technical data.

It is a reversible dimple key system which covers basic security levels.

### Characteristics

- Type: Dimple key. (Brass nickel plated).
- NO. of rows: 1
- NO. of pins: 6
- Combination level: Grade 5
- Technology: Tumbler regular.
- Corrosion resistance: Grade B.
- Anti pick system.
- Drill resistant.
- Bump proof cylinder lock.
- Lifespan: 100,000 test cycles.
- 3 keys per cylinder.
- Conform to EN-1303 regulation

### Options

- Double security clutch.
- Modular. (For unusual measures or anti snap protection)
- Cams: DIN R15, R13 and different pinion gears.
- Finishes: Brass / Nickel plated.
- Formats available: Key different, master keyed, key alike and specific codes.
- Wide measurement and profile range.

### Master key systems.

Appropriated model for those master key suites where the levels of complexity are not too high.

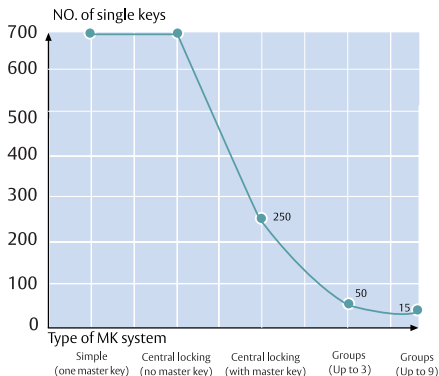

### Security

\*\*

### Masterkeying

\*



### European standard regulation.

T60 is certified according to the standard EN 1303 regulation, getting the following results.

1	6	0	1	0	B	5	0
Key resistance (Grade 0-1)	Lifespan (Grade 4-6)	Door mass (Not applied in cylinder)	Fire resistance (Grade 0-1)	Safety of the people (Not applied in cylinders)	Corrosion and temperature resistance (Grade 0-A-B-C)	Key related security (Grade 1 to 6)	Attack resistance (Grade 0 to 2)

\*Note: with the shield E700 the attack resistance rise to the level 2.

### Recommendations

- Use TESA lubricant to lengthen the maximum lifespan of the cylinder.
- Use original keys to make copies.
- For safety reasons, when you select a new cylinder, remember that once installed, it should not project more than 1mm.



T60 Blister Pack

## Security cylinder T60

### European profile

#### Double Cylinder

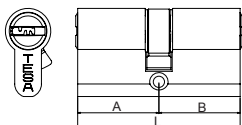

L	A	B	Cam = 15 mm	Finish	U/Price
60	30	30	T635 30 30 L	Brass	
70	35	35	T635 35 35 L	Brass	
80	40	40	T635 40 40 L	Brass	
90	45	45	T635 45 45 L	Brass	
100	50	50	T635 50 50 L	Brass	
60	30	30	T635 30 30 N	Nickel	
70	35	35	T635 35 35 N	Nickel	
80	40	40	T635 40 40 N	Nickel	
90	45	45	T635 45 45 N	Nickel	
100	50	50	T635 50 50 N	Nickel	

#### Half Cylinder

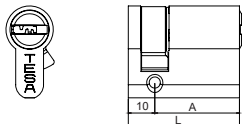

L	A	B	Cam = 15 mm	Finish	U/Price
40	30	10	T635 30 10 L	Brass	
45	35	10	T635 35 10 L	Brass	
40	30	10	T635 30 10 N	Nickel	
45	35	10	T635 35 10 N	Nickel	

#### Single Cylinder

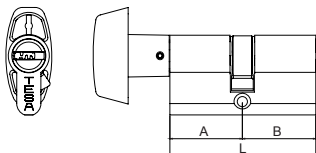

L	A	B	Cam = 15 mm	Finish	U/Price	Cam = 15 mm	Finish	U/Price
60	30	30	T63B 30 30 L	Brass		T63B 30 30 LA	Antique Brass	
70	35	35	T63B 35 35 L	Brass		T63B 35 35 LA	Antique Brass	
80	40	40	T63B 40 40 L	Brass		T63B 40 40 LA	Antique Brass	
90	45	45	T63B 45 45 L	Brass		T63B 45 45 LA	Antique Brass	
100	50	50	T63B 50 50 L	Brass				
60	30	30	T63B 30 30 N	Nickel				
70	35	35	T63B 35 35 N	Nickel				
80	40	40	T63B 40 40 N	Nickel				
90	45	45	T63B 45 45 N	Nickel				
100	50	50	T63B 50 50 N	Nickel				

#### Screw in Cylinder

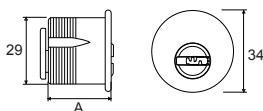

A	Ø = 29 mm	Finish	U/Price	Ø = 29 mm	Finish	U/Price
25	T63BR10PVD	Brass		T63BR10LA	Antique Brass	
29	T63BR118PVD	Brass		T63BR118LA	Antique Brass	
32	T63BR114PVD	Brass		T63BR114LA	Antique Brass	
35	T63BR138PVD	Brass		T63BR138LA	Antique Brass	
38	T63BR112PVD	Brass		T63BR112LA	Antique Brass	
42	T63BR158PVD	Brass		T63BR158LA	Antique Brass	
25	T63BR10NM	Nickel				
29	T63BR118NM	Nickel				
32	T63BR114NM	Nickel				
35	T63BR138NM	Nickel				
38	T63BR112NM	Nickel				
42	T63BR158NM	Nickel				

#### Deadbolt Cylinder

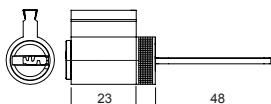

L = 23 mm	Finish	U/Price
CILT60SCHLAGEL T	Brass	

## Security cylinder T80

Technical data.

Reversible dimple key with open key blank distribution.

### Characteristics

- Type: Dimple key. (Nickel silver).
- NO. of rows: 2
- NO. of pins: 8
- Combination level: Grade 6
- Corrosion resistance: Grade B.
- Anti pick cylinder lock.
- Drill resistant.
- Bump proof model.
- Lifespan: 100,000 test cycles.
- 3 keys per cylinder.
- Conform to EN-1303 regulation

### Options

- Double security clutch.
- Modular. (Specially designed for either unusual measurements or anti snap protection)
- Cams: DIN R15, R13.
- Finishes: Brass / Nickel.
- Formats available: Key different, master keyed, key alike and specific codes.
- Wide measurement and profile range.

Security ***	Masterkeying ***
-----------------	---------------------



### Master key systems

The eight position chambers and the possibility of varying side pins makes T80 the most suitable option for those master key systems where the number of key functions is large and the copy control is not required.

### Recommendations

- Use TESA lubricant to lengthen the maximum lifespan of the cylinder.
- Use original keys to make copies.
- For safety reasons, when you select a new cylinder, remember that once installed, it should not project more than 1mm.

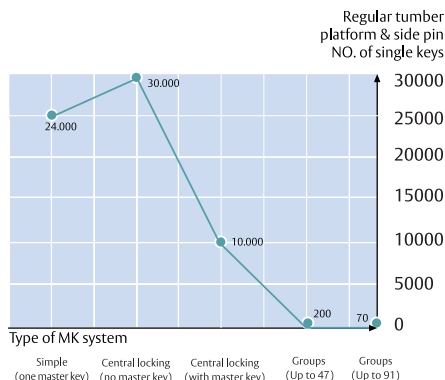



T80 Blister Pack

## Security cylinder T80

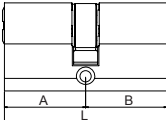
### European profile

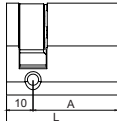
Double Cylinder		L	A	B	Cam = 15 mm	Finish	U/Price	
		60	30	30	T835 30 30 L	Brass		
		70	35	35	T835 35 35 L	Brass		
		80	35	45	T835 35 45 L	Brass		
		80	40	40	T835 40 40 L	Brass		
		100	50	50	T835 50 50 L	Brass		
		60	30	30	T835 30 30 N	Nickel		
		70	35	35	T835 35 35 N	Nickel		
		80	35	45	T835 35 45 N	Nickel		
		80	40	40	T835 40 40 N	Nickel		
		100	50	50	T835 50 50 N	Nickel		

Half Cylinder		L	A	B	Cam = 15 mm	Finish	U/Price	
		40	30	10	T835 30 10 L	Brass		
		45	35	10	T835 35 10 L	Brass		
		40	30	10	T835 30 10 N	Nickel		
		45	35	10	T835 35 10 N	Nickel		

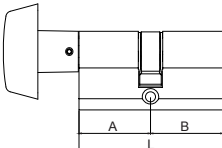
Single Cylinder		L	A	B	Cam = 15 mm	Finish	U/Price	Cam = 15 mm	Finish	U/Price
		60	30	30	T83B 30 30 L	Brass		T83B 30 30 LA	Antique Brass	
		70	35	35	T83B 35 35 L	Brass		T83B 35 35 LA	Antique Brass	
		80	35	45	T83B 35 45 L	Brass				
		80	40	40	T83B 40 40 L	Brass				
		80	45	35	T83B 45 35 L	Brass				
		60	30	30	T83B 30 30 N	Nickel				
		70	35	35	T83B 35 35 N	Nickel				
		80	35	45	T83B 35 45 N	Nickel				
		80	40	40	T83B 40 40 N	Nickel				
		80	45	35	T83B 45 35 N	Nickel				

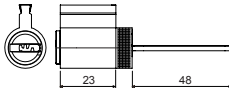
Deadbolt Cylinder		L = 23 mm				Finish	U/Price	
						CILT80SCHLAGELT	Brass	

## Security cylinder T80

### Round profile

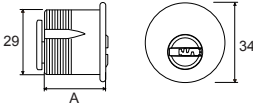
Screw in Cylinder		A	Ø = 29 mm	Finish	U/Price	Ø = 29 mm	Finish	U/Price
	25	T83BR10PVD	Brass			T83BR10LA	Antique Brass	
	29	T83BR118PVD	Brass			T83BR118LA	Antique Brass	
	32	T83BR114PVD	Brass			T83BR114LA	Antique Brass	
	35	T83BR138PVD	Brass			T83BR138LA	Antique Brass	
	38	T83BR112PVD	Brass			T83BR112LA	Antique Brass	
	42	T83BR158PVD	Brass			T83BR158LA	Antique Brass	
	25	T83BR10NM	Nickel					
	29	T83BR118NM	Nickel					
	32	T83BR114NM	Nickel					
	35	T83BR138NM	Nickel					
	38	T83BR112NM	Nickel					
	42	T83BR158NM	Nickel					

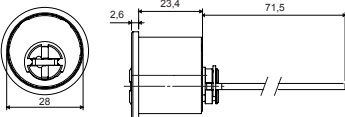
Rim Lock Cylinder		Ø = 28 mm	Finish	U/Price	Ø = 28 mm	Finish	U/Price
	TS8REGU LT	Brass			TS8REGU LN	Nickel	

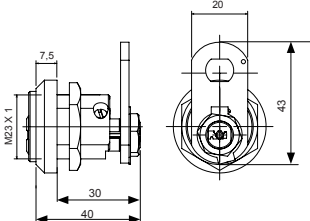
Cam Lock		Metric	Type	Code No.	Finish	U/Price
	23	Mechanic		682M23T8NM	Nickel	

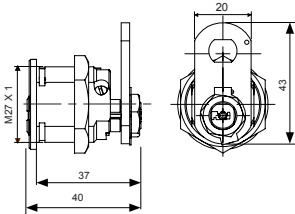
Cam Lock		Metric	Type	Code No.	Finish	U/Price
	27	Mechanic		682T8NM	Nickel	



## High security cylinder TK6

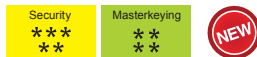

### Technical data

New model designed to cover two basic necessities in the market. On the one hand has been made with an exclusive and patented combination technology to solve complex master key suites and on the other hand a new security sensor lets the owner control all the keys in one installation.

### Characteristics

- Type: Patented sawn key with security sensor.
- NO. of rows: 1
- NO. of pins: 6.
- Technology: DROP ORBITAL (Exclusive TESA rights)
- Permutation level: Grade 6.
- Corrosion resistance: Grade B
- Anti pick cylinder lock (High resistance.)
- Bump proof system.
- Drill protection grade 1.
- 3 patented keys made of nickel silver.
- Conform to EN-1303 regulation.
- Lifespan: 100,000 test cycles.
- Master key systems: Medium capability in combination with DROP ORBITAL platform.

### Options

- Finishes: Brass / Nickel.
- Cam: DIN R15 and R13
- Formats available: Key different, mater keyed, key alike and specific codes.
- Wide measurement and profile range.
- Colour points to differentiate master key levels.

### Master key system

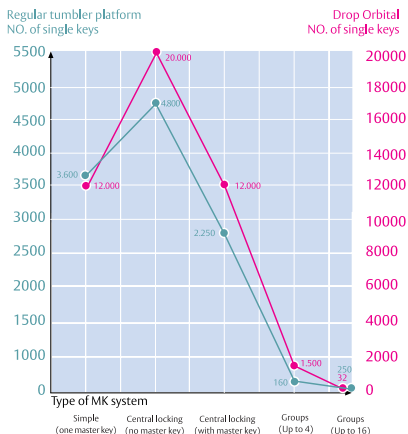

### European standard regulation

In the same way as the main models included in the catalogue, the TK6 is certified according to the European standard regulation.

1	6	0	1	0	B	6	0
Key resistance (Grade 0-1)	Lifespan (Grade 4-6)	Door mass (Not applied in cylinder)	Fire resistance (Grade 0-1)	Safety of the people (Not applied in cylinders)	Corrosion and temperature resistance (Grade 0-A-B-C)	Key related security (Grade 1 to 6)	Attack resistance (Grade 0 to 2)

\*Note: with the shield E700 the attack resistance rise to the level 2.

### Recommendations

- Use TESA lubricant to lengthen the maximum lifespan of the cylinder.
- TESA recommends to the user of the TK6 to keep the property card in a safe and secure location. Only by presenting this card, can one obtain key and cylinder copies.
- For safety reasons, when you install a new cylinder, remember that once installed, it should not project more than 1mm.



TK6 Blister Pack

## High security cylinder TK6

Double Cylinder

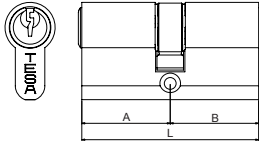

L	A	B	Cam = 15 mm	Finish	U/Price	Finish	U/Price
60	30	30	TK635 30 30	Brass		Nickel	
70	35	35	TK635 35 35	Brass		Nickel	
80	40	40	TK635 40 40	Brass		Nickel	
90	45	45	TK635 45 45	Brass		Nickel	

Half Cylinder

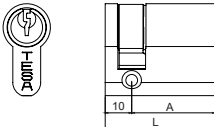

L	A	B	Cam = 15 mm	Finish	U/Price	Finish	U/Price
40	30	10	TK635 30 10	Brass		Nickel	
45	35	10	TK635 35 10	Brass		Nickel	

Single Cylinder

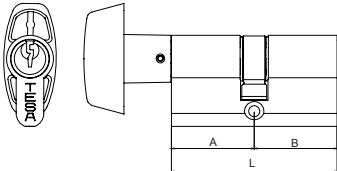

L	A	B	Cam = 15 mm	Finish	U/Price	Finish	U/Price
60	30	30	TK63B 30 30	Brass		Nickel	
70	35	35	TK63B 35 35	Brass		Nickel	
80	40	40	TK63B 40 40	Brass		Nickel	
90	45	45	TK63B 45 45	Brass		Nickel	

Combo (Double & Single Cylinder)

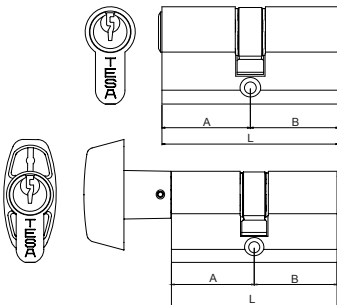

L	A	B	Cam = 15 mm	Finish	U/Price	Finish	U/Price
			TK635 30 30	Brass		Nickel	
			TK63B 30 30				
			TK635 30 30	Brass		Nickel	
			TK63B 35 35				
			TK635 35 35	Brass		Nickel	
			TK63B 35 35				

## Stand alone access control

Proximity technology card



STAC12SL1S008VI

STAC12XL1S008VI

Standard

### Electronic lock

- Slim design that allows the installation in every door type.
- Wide range of lever designs and mortise locks.
- Two different aesthetics: long plate or rose handle + independent reader.
- No wirings. Standard battery-powered lock.
- Nor software, neither management devices needed.
- Unlimited nr. of doors, up to 500 different users per door.
- Identity technology: 13,56 MHz MIFARE standard.
- Finishes: Stainless steel.
- Distance between axes: 85mm.
- Square spindle 8 mm.
- All the control components (excepting the reader module) are placed in the inside escutcheon, therefore offering anti-vandalism protection.
- Emergency key override.

### NO SOFTWARE, NO MANAGEMENT EQUIPMENT



CD



PC



ENCODER  
SmartAir



Portable  
programmer



Optional

To order specify X and Y distances (see picture).

- The lock includes one user keycard. Programming and user cards, mechanical cylinder and mortise lock to be ordered separately.
- Mortise locks with standard follower. Split follower can not be used.

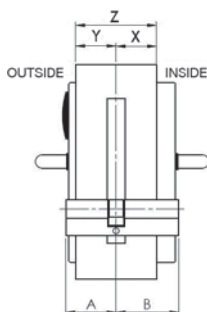

Code No.	Description
STAC12SL3V858VI	Standalone lock for inside door, long plate, visible cylinder, vector handle, stainless steel
STAC12XL3V858VI	Standalone lock for external door, long plate, visible cylinder, vector handle, stainless steel
STAC12SC3S858VI	Standalone lock for inside door, short plate, visible cylinder, vector handle, stainless steel
STAC12XC3S858VI	Standalone lock for external door, short plate, visible cylinder, vector handle, stainless steel

## Stand alone access control

Proximity technology card

### Autoprogrammable wall reader

The reader activates the locking element with a relay: electric strike, electromagnetic/motorized lock, etc. 12Vac/Vdc external power supply required.

Connectors	Description
CN1	12Vac/Vdc power supply Standby consumption 80 uA
CN2	Consumption with operating relay: 150 mA
CN3	Relay backset: NO, NC and C. Cut capacity: 5A 250Vac/5A 30Vdc
CLR	RESET button for the erasing of the reader's memory
Operation conditions	Description
Humidity	Up to 85% without condensations
Temperature	-10° - 80°C

Noises of the electric strike: we recommend installing the VARISTOR (which is included in the package) in the electric strike in order to absorb the noises it may produce. ALTERNATING CURRENT ONLY



STAR2PUSSB

STAR2PDSSI

### Mounting diagram

Delivered in a 1/1 box with screws, varistor, power supply and installation templates.

Once connected, and up to the moment when it has been programmed with the programming keycard, the reader is in.

Code No.	Description
STAR2PUSSB	Stand alone universal wall reader
STAR2PDSSI	Stand alone design wall reader

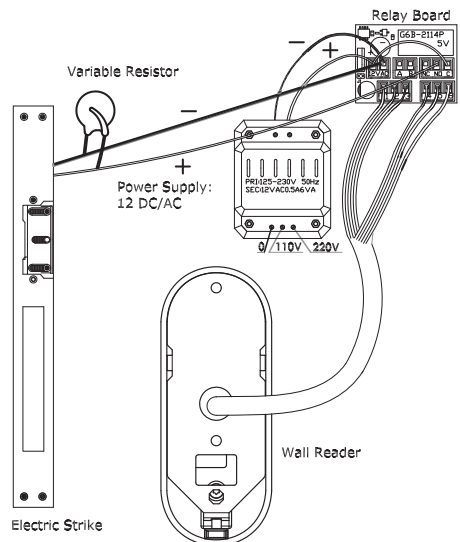

## Stand alone access control

Proximity technology card

### Autoprogr. management kit

In order to start using an autoprogrammable SmartAir access control we require neither costly computer systems nor learning to use complex managements programs. All we need is a Programming card (which identifies an installation, making it different from the rest) and as many cards as users are required by the installation.

TESA has brought together all these elements in a kit, along with a simple tool that performs emergency opening when the system runs out of batteries.



Code No.	Description
STACKITASDW	Stand-alone shadow kit: includes programming shadow card, 24 key cards (12 users, 12 shadow cards) and emergency opening battery.

### Programming card

Its unique, exclusive code will allow to program as many locks as is required by the installation. You can rest assured that no other programming card will be taken into account from that moment on.

The programming card with Shadow function allows to:

- Add users and their shadow cards.
- Add users with option to leave the door in passage mode and their shadow cards.
- Lost card cancellation in the lock through the shadow card.
- Cancel all the users at a time.



Code No.	Description
STACLICSTA	Programming card
STACKICSTASDW	Programming shadow card



### User cards

Ready to be included in the list of users allowed by each door, they will have to be presented to the lock before they've been allowed access.

### Simple functionality

By installing three AAA batteries in this element, and once it has been connected to the lock, we will be able to replace the internal batteries in case the system runs out of them. Once it's been connected, the door will allow access to any authorized card.



Code No.	Description
STACKITEMERG	Emergency opening battery

## Stand alone access control

Proximity technology card

### Program standard users

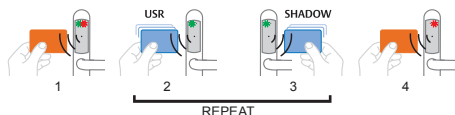

1. Open programming mode with programming card.
- 2-3. Present 2 user cards one followed by the other (green light will flash faster) the second card will be the shadow card of the first one.
4. Close programming mode (it is also automatically closed after 10 seconds).

Note: If only one user card is presented, the user will not be programmed and it will not have access.

### Program passage functionality user

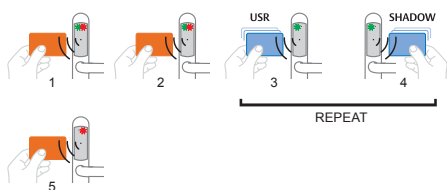

- 1-2. Open Passage Functionality programming mode placing two times the programming card (lights will flash faster on second approach).
- 3-4. Present two user cards one followed by the other (green light will flash faster) the second card will be the shadow card of the first one.
5. Close programming mode (it is also automatically closed after 10 seconds).

Note: If only one user card presented, the user will not be programmed and it will not have access.

### Start / stop passage mode

Start passage mode



- 1-2. To leave an Smartair Standalone Escutcheon or wall reader in passage mode place two times a Passage Functionality User card (green light will flash).
- 3-4. To finish the passage mode place again two times a Passage Functionality user cards (green light flashing + constant red light).

### Delete one user

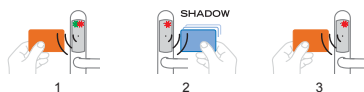

1. Open programming mode with programming card.
2. Present the shadow card of the user that wants to be deleted.
3. Close programming mode (it is also closed automatically after 10 seconds).

### Cancel all cards

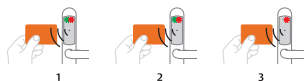

- 1-2-3. Place 3 times the programming card.

### Opening with low batteries (only escutcheon)

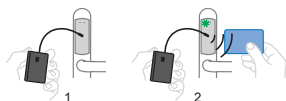

Escutcheon flashes red & green lights approaching a card when batteries are low.

1. Connect the emergency power supply kit.
2. Place a valid user card to open the door and change the batteries of the escutcheon.

## Stand alone access control

Proximity technology card

### Combi key RFID

The RFID COMBI key from TESA allows mechanical master key systems to be compatible with TESA Standalone or other access control systems in only one device or credential. COMBI key can be compatible with mechanical T80 cylinders, furthermore, user will also have access to RFID MIFARE technology electronic lock or wall readers simply approaching the key head.

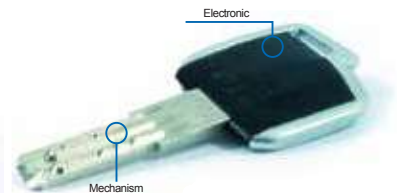

## Stand alone access control

Electronic key

### Stand alone electronic cylinder

- Quick installation, just as a mechanical cylinder.
- The cylinder has no power supply. The key supplies the energy required in order to open.
- Autoprogrammable system – you just need a programming key and user's keys.
- All the monitoring elements are located inside the cylinder, and therefore protected: control unit, reader and deadbolt device.
- In the outdoors version, the electronic cylinder is resistant to water and to adverse climatic conditions.
- It is possible to have a stock of replacement cylinders that can be easily recorded and integrated with the installation.
- It is possible to combine in one installation TESA's mechanical and electronic cylinders.



### Types of cylinders

All the necessary elements (control unit, reader and motorized clutch) are located in one side of the cylinder, with a minimum length of 35mm.

Version	
Standard	For internal doors
Outdoors (optional)	Water resistance
	All the electronic elements have been silicon-coated and protected with sealing joints. IP54 degree of protection from humidity and condensation.
Lengths	
Minimum	Half cylinder 35x10 mm. (optional) Double cylinder 35 x 35 mm.
Supplements	5mm intervals in any side with a maximum total (for both sides) of 120 mm or 75 mm on one side. Ask for other sizes.
Excentric	
13,2 mm (optional)	Ironwork doors with eccentric lock 13,2
15 mm	Other doors
Finishes	
Nickel	



Half cylinder  
(STAXSE535E10MN)



Electronic - Electronic  
(STAXSE535E35EN)

(STAXXE535E10MN)

(STAXXE535E35EN)



Electronic - Thumbturn  
(STAXSE535E35BN)



Electronic - Mechanical  
(STAXSE535E35MN)

(STAXXE535E35BN)

(STAXXE535E35MN)



## STX electronic cylinder

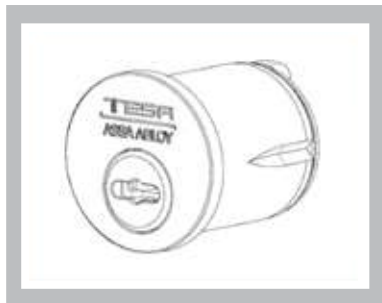

**Tesa Electronic Cylinders are elements integrated in the access control system, which are intuitive efficient and both easy to use and install. Ideal for new builds or retrofit purposes.**

### Functionality

- Immediate installation, in the same way as mechanical ANSI profile cylinders.
- Autonomous operation, write-free installation. Key provides energy to open.
- All control elements inside the cylinder offering greater security against vandalism.
- Offers read and write functionality: Events can be stored in the key as well as modifications in the Access plan that can be dumped in the cylinder.
- Possibility to combine in the same installation, electronic cylinders, electronic RFID locks and mechanical cylinders.
- Extreme version: cylinder is resistant to water and adverse weather conditions IP57.

### Electronic Characteristics

#### Reader module:

- Identification via read/write contact chip
- Activation Mode: Cylinder is activated when key inserted. Energy efficient.

#### Control Unit:

- Non-volatile memory
- It can be programed to operate in 3 modes:
  - 1500 users & 600 events
  - 1000 users & 100 events
  - High traffic: unlimited users divided in 48 groups & 600 events

#### Operating conditions:

- Standard: Interior doors
- Extreme: Water resistant IP57

### Mechanical Characteristics

- Minimum length 1¼
- No mechanical pins codification required on the key (only for mechanical cylinders if used).
- Available lengths:
  - 1¼
  - 1½
  - 1¾
  - 2
  - 2¼
  - For other lengths contact Tesa for availability

Electronic Screw in Cylinder	Length	
STAXSETBRA114A, STAXSETBRA114D, STAXSETBRA114N	(32mm) 1¼	
STAXSETBRA138A, STAXSETBRA138D, STAXSETBRA138N	(35mm) 1¾	
STAXSETBRA112A, STAXSETBRA112D, STAXSETBRA112N	(38mm) 1½	
STAXSETBRA158A, STAXSETBRA158D, STAXSETBRA158N	(42mm) 1¾	
STAXSETBRA134A, STAXSETBRA134D, STAXSETBRA134N	(45mm) 1¾	

## Stand alone access control

Pin code



### Easy and convenient

CodeHandle is a set of handles with access control without any cards or keys, simple and effective. Its suitable for any kind of interior door, in residential or institutional environments where comfortable and ease of use its a priority. Code handle is the solution for most of the restricted areas: offices, warehouses, private areas, wardrobe, etc.

#### Attractive design and easy to install

As the keyboard is integrated in the handle is a more attractive option than the wall readers. Also is very easy to install: without cables, without special drills... you can install it as any other handle.

#### Technical features:

- In doors: patented stand alone access control with code for internal door. A complete set is supplied including handles, rosettes, spindle, fixing through bolts and instructions. For 35 - 80 mm door thickness.
- In windows, the handle is supplied with fixing screws and instructions.
- Fits lock cases DIN standard. 8 mm spindle.
- One master code and up to nine different user codes.
- Auto locking function available.
- Two CR2, 3V lithium batteries in the outer handle.
- Visual and acoustic feedback.
- Easy to fit, no cables.
- Available for right- and left hand doors.
- Only for indoor use.
- Material: brushed stainless steel and satin chrome zink.



#### Function:

- Four buttons to press a four- to six digit code to unlock and one button to lock.
- Green light flashes and a sound is heard when the buttons are pressed for unlocking.
- Red light flashes and a sound is heard when locking.
- Master code and user code is programmed at installation. Can be changed unlimitedly.
- If wrong code is pressed five times the handle is blocked for three minutes.
- Free swing from the outside when locked, always possible to open with the handle from the inside.
- The two batteries gives approximately 100,000 operations.
- Red light indicates low battery when approximately 500 operations left

#### Market

CE according to EN 61000-6-1, EN 61000-6-3, EN61000-4-2, EN 61000-4-3, EN61000-4-8

## Stand alone access control

Electronic key

### Electronic key

- Non-volatile memory of the key. No information will be lost when the battery is used up or replaced.
- Protected data prevent the key from duplication.
- One only red authorization key for each installation ensures that only the person in charge of the key will be able to record keys and cylinders.
- Reading and writing contact chip.
- Great capacity for storing and protecting data.
- Encrypted data transmission between the cylinder and the key.



T80 Mifare Electronic key  
STALXCTSNGNT

### Operation conditions

Humidity	Temperature
Up to 85% without condensation	-20°C / 70°C

### Types of key

Options	
Electronic Key	(Uncarved) for installations with electronic cylinders
T80 carved key	To be combined with mechanical cylinders (T80 system)

Technical Features	
Size	95 x 36 x 9 mm
Technology	Contact chip
Power supply	Type of battery: CR 2032 Li-Mn 3V Estimated duration: > 10,000 operations
Warning LED	Green LED: authorized access.
	Red LED: denied access.
	Flashing LED: low battery warning

NON SOFTWARE, NO MANAGEMENT EQUIPMENT



CD



PC



EDITOR  
SmartAir



PP



Electronic key  
(STALXCTSNGNT)



T80 carved key  
(STALXCTSTGNT)

Type	Use	Cam	Electronic side	Mechanic side	Finish	Code No.
Electronic mechanical cylinder (STAX)	Standard (S)	15mm (5)	35E	35E	Nickel (N)	STAXSE535E35MN
Electronic thumbturn (STAX)	Standard (S)	15mm (5)	35E	35B	Nickel (N)	STAXSE535E35BN
Electronic - electronic (STAX)	Standard (S)	15mm (5)	35E	35B	Nickel (N)	STAXSE535E35EN

- No wirings, no battery needed. The system works feeded through a standard battery in the key.
- No software, no management station are needed.
- Unlimited number of doors; up to 500 users per door.
- Product range: e - cylinders, half e - cylinders, e - knobsets and e - padlocks.
- Electronic keys can open as well masterkeyed mechanical cylinders T80

### Programming key and autoprogrammable kit

Code No.	Description
STAXKITSTA	Stand alone kit (programming key + 3 users keys)
STAXLICSTA	Programming key

### User keys

Type	Format	Compatible with	Code No.
TS	Blank	T80	STALXCTSNGNT

## Stand alone access control

Electronic key

### Autoprogrammable management kit

The autoprogrammable cylinder brings you all the advantages and flexibility of the access control offline cylinder while at the same time sidestepping the complications derived from the management devices they include.

The autoprogrammable management Kit includes: a (red) programming card and three (grey) user keys.

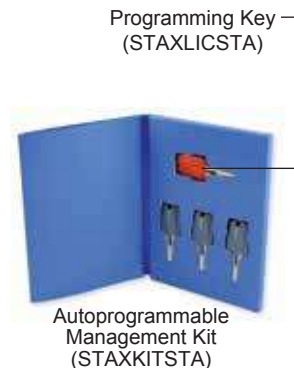

#### Users register

1) Start the programming sequence by inserting the (red) programming key in the cylinder. The key's light will shine in red and green colours several times.

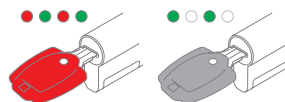

2) Insert the key you wish to authorize. The key's light will shine in green, flashing several times.

Repeat steps 1 and 2 for each key you wish to register in the cylinder.

#### Delete users

1) Start the programming sequence by inserting the (red) programming key in the cylinder. The key's light will shine in red and green colours several times.

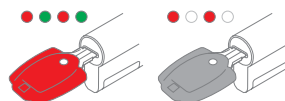

2) Insert the key you wish to delete. The key's light will shine in red, flashing several times.

Repeat steps 1 and 2 for each key you wish to delete from the cylinder.

#### Erase all

1) Start the programming sequence by inserting the (red) programming key in the cylinder. The key's light will shine in red and green colours several times.



2) Insert for the second time the programming key. The key's light will shine in red, flashing quickly several times. The cylinder is warning us that total erasure is going to take place.

3) Insert for the third time the programming key. The key's light will shine in red permanently for a few seconds. The cylinder is now empty.

## Stand alone access control

Pin code

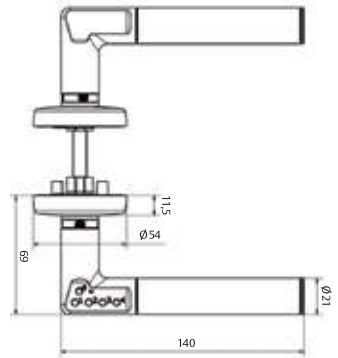

## Locks for wooden doors

403050AI – Latch lock with 50mm backset with half cylinder  
 30 x 10 mm. 134U5RAI – Latch lock with 50mm backset.

Handle for door	Code No.	Finish	Hand
	MCHIR800	CM	Left
	MCHDR800	CM	Right

### IMPORTANT

To make the emergency opening easier we recommend to install TESA Code handle with a mortise lock with cylinder.



134U5RAI (optional)

## Hands of the doors from the Codehandle side (exterior):

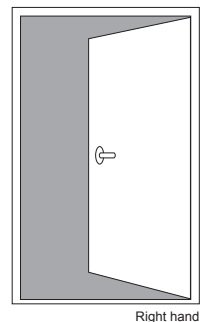
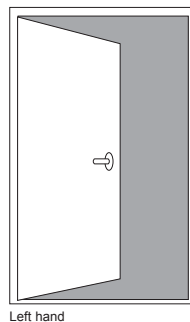
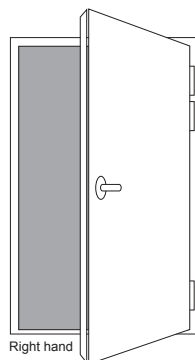
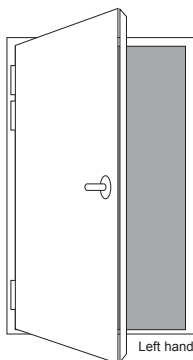

## ENTR™

KEY FREE. BE FREE

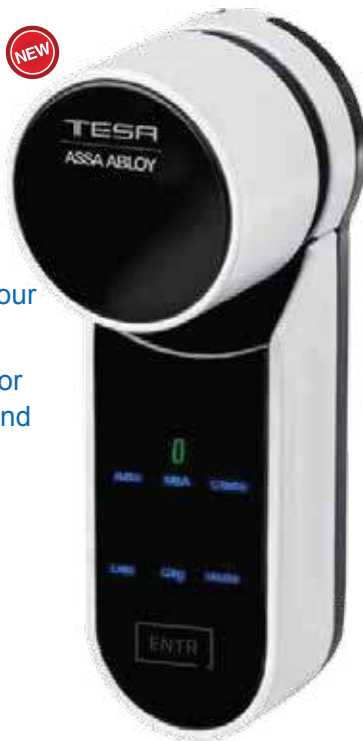

- Unlock using your Smartphone
- Self-locking door for peace of mind
- Easy to install



ENTRKIT1T603035

ENTRKIT1T603535

ENTRKIT1T604040

ENTR™ is the revolutionary smart lock solution that allows you to control your door lock from your Smartphone, tablet and other Bluetooth enabled devices



**ASSA ABLOY**

ASSA ABLOY, the global leader  
in door opening solutions

# DIGITAL LOCK



With ENTR™'s App you can lock and unlock your door, right from your smartphone, tablet or other Bluetooth-enabled device, giving you 24/7 control and management capabilities.

- » Uses encrypted Bluetooth smart technology, non-dependent on network reception
- » Receive notifications – locked / unlocked door, battery power level
- » Create virtual keys and program scheduled access authorizations
- » Technical support interface using your smartphone



## ENTR™ Solution Highlights:

- » Ideal for most door types and sizes
- » Easy to install on your existing door – no drilling or wiring
- » Battery operated – not dependent on power or cables
- » Secure, encrypted wireless communication between system elements
- » Automatic locking – shut the door and it will automatically lock

## High Security Access Options

ENTR™ provides you with a variety of devices that give you access control. Select those that best suit your needs and provide you with the most convenience.

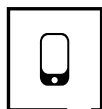

Smartphone



Remote

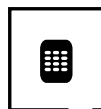

Code



Fingerprint



ENTRM-REMOTE CONTROL    ENTRTN-KEYPAD    ENTRETB-BIOMETRIC

## Link arm door closers

### CT500

The CT500 is a door closer that offers good performance in a compact size.

It can drive doors from size 2 to 3. This means that the CT500 will feel comfortable closing doors weighing from 40 to 60 Kg. and up to 950mm. door width.

This capability is achieved in a single model thanks to the variable position installation system.

- Rack and pinion mechanism for smooth and reliable operation.
- Two valves to adjust both sweep and latch speeds separately.
- Two sizes (EN2&EN3) in a single model.
- Reversible.
- Suitable for doors opening inwards or outwards.:  
**Standard mounting:** Door opens INWARDS, mounting on the pull side.  
**Transom mounting:** Door opens OUTWARDS, mounting on the push side.

- Finishes: Silver

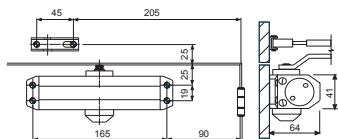

Standard mounting:

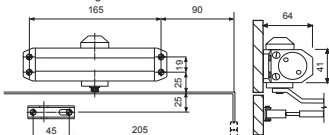

Transom mounting:

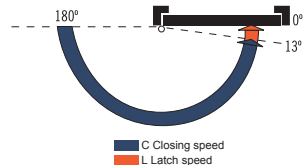

Code No.	Size	Door width mm	Door weight Kg	Opening	Adjustable
CT500	2	850	40	180°	S L
(non hold open)	3	950	60	180°	S L



## Push type panic exit devices

### Universal series

The various functions presented by these serie provide solutions for any type of assembly, both for single and double leaf doors.

All models present the following features:

- Easily reversibility.
- Compatible with firebreak doors.
- External operation with:
  - Modular handle: its European-profile 30x10 mm cylinder makes it fit for installation in doors of varying degrees of thickness.
  - Sena handle: equipped with an adjustable cylinder for 32-to-80 mm-thick doors.
- Narrow support pieces for small size profiles.
- It can incorporate a microswitch.
- Easy to install thanks to:
  - Vertical rod devices are adjusted to 40 mm
  - The horizontal bar can be cut in order to adjust them to the door width.
- Standard finish:
  - Support pieces, vertical rod devices and auxiliary locks in BLACK (RAL 9005).
  - Active bar in GREEN (RAL 6002).
  - Other finish combinations can be ordered:

Auxiliary locks, covers, and vertical rod devices	Horizontal bar							
	P	V	R	N	C	I	LT	B
N		•	•	•	•	•		
S					•	•		
I						•		
P	•							
LT							•	
C					•			
B								•

N: black (RAL 9005)  
V: green (RAL 6002)  
R: red (RAL 3000)  
P: silver (RAL 9006)  
B: white (RAL 9010)  
S: satin (nickel plated)  
LT: brass  
C: chrome  
I: stainless (AISI304)

Finishes examples:  
NV: black - green  
II: stainless - stainless  
LT: brass - brass  
...



Reversibility



Narrow support pieces



Adjustment

## Push type panic exit devices

### Rim model: 1910

Rim panic device with a lateral lock point.

Steel swing latch.

Outside devices; see inferior table.

EN 1125 certification:

3 7 6 B 1 3 2 2 A A



The box includes:

- 1 main support and another secondary one.
- 1 oval shaped horizontal bar, 900 mm in length.
- Accessories: Fixing screws, screws witch support the horizontal bar, 1 square spindle and strike.
- Assembly instructions and installation template.

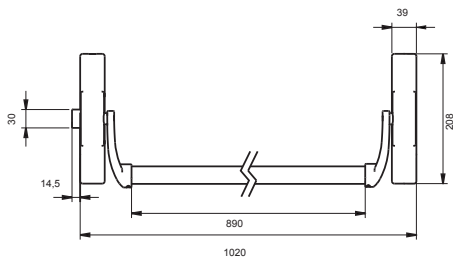

Model	Bar length	Squared spindle mm	Cover finish mm	Bar finish
1910	90	8	N	V=Green
1910	90	8	N	I=Silver



## Configuration

1 leaf door

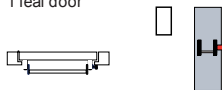

2 leaf door

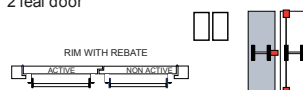

Door configuration for 1910 and 191E models

Outside device	Lever handle with euro-profile	Modular lever handle
Cylinder locking	lever handle opening	

## Push type panic exit devices

### Rim model: 1920

Rim panic device with 2 locking points with steel roller bolts.

Used when a rim strike can not be installed in the lower locking point.

EN 1125 certification:

3 7 6 B 1 3 2 2 A A

The box includes:

- 1 main support and a secondary one.
- 1 oval shape horizontal bar of 900 mm in length.
- 2 vertical rods of 930 mm.
- Accessories bag includes: Fixing screws, screws with support the horizontal bar, 1 square spindle, 2 vertical rod guides and strikes.
- Assembly instructions and installation template.
- 2 locking points, upper and lower.

Code No.	Bar length	Squared spindle mm	Cover finish mm	Bar finish
1920	900	8	N	V

NOTE: no back place for cylinder

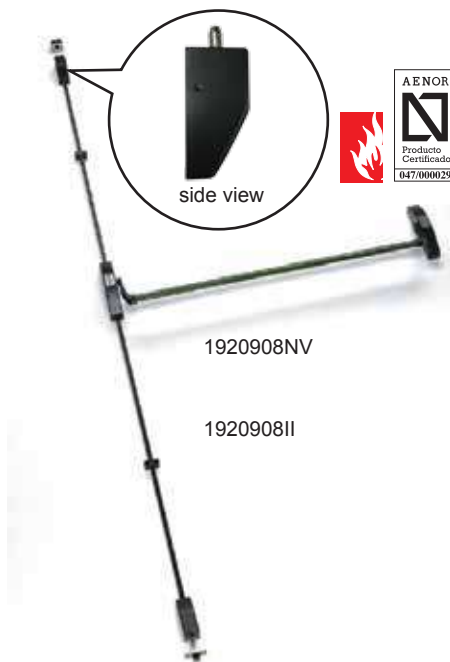

1920908NV

1920908II

## Configuration

1 leaf door

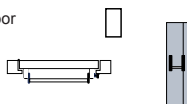

2 leaf door

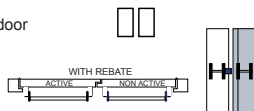

2 leaf door

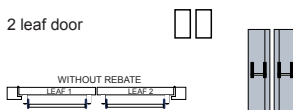

Outside device	Lever handle with euro-profile	Modular lever handle
Cylinder locking	lever handle opening	•

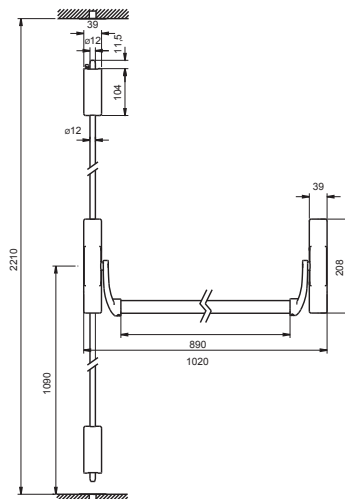

## Touch Type Panic Exit Device. Quick Series

### Rim model. QUICK1S

Rim panic device with one lateral locking point.  
 Steel or zink alloy swing latch.



(\*Optional)

EN 1125 certification:

3 7 6 0/B\* 1 3 2 2 B A

The box includes:

- » 1 horizontal bar and a modular head.
- » Accessories: Fixing screws, strike, follower and base plate.
- » Assembly instructions and installation template.



QUICK1S nickel plated finish

Options
Steel pullman latch*
Standard dogging devices
Cylinder dogging devices
Deadlatch (DL)
Floor strike
Zink alloy strike
Adjustable strike
Door width = 1200 mm

\* Include DL

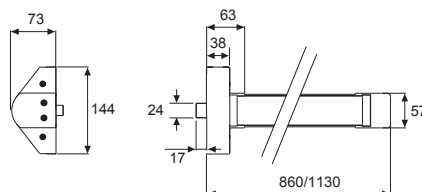

Pullman latch	Deadlatch	Dogging devices	Strike	Door width	Cover finish	Bar finish
Zink alloy	No	No	Steel	1200	Silver	Silver

### Configuration

1 leaf door

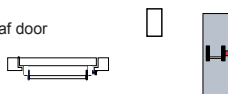

2 leaf door

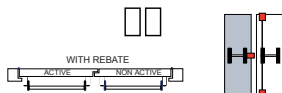

Outside device	Blind plate	Modular lever handle
No outside opening	•	•
Free passing door		•
Cylinder looking	Knob / lever handle opening	•
	Key opening	•

## Touch Type Panic Exit Device. Quick Series

### Rim model. QUICK3S

Rim panic device with 2/3 vertical locking points.  
Steel or zink alloy swing latch.

EN 1125 certification:

3 7 6 0/B\* 1 3 2 2 B A

The box includes:

- » 1 horizontal bar and a modular head.
- » Accessories: Fixing screws, strike (top, bottom and central), follower, cover for central locking point and base plate.
- » 2 vertical rod devices (L=1090mm).
- » 2 locking points (upper and lower).
- » Assembly instructions and installation template.



MNBT101V02SSGGT

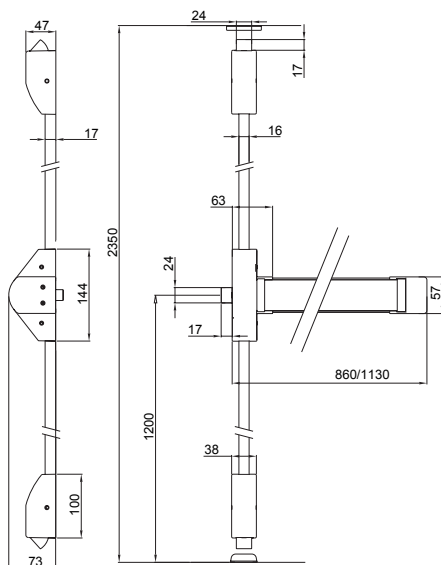

Options
Standard dogging device (no FR)
Cylinder dogging device (no FR)
Floor strikes
Zink alloy strike (no FR)
Adjustable strike (no FR)
Door width = 1200 mm
Vertical rod device cover

Pullman latch	Deadlatch	Dogging device	Strike	Door width	Vertical rod device cover	Cover device	Bar finish
Zink alloy	No	No	Steel	1200	No	Silver	Silver

Outside device	Blind plate	Modular lever handle
No outside opening	•	•
Free passing door		•
Cylinder looking	Knob / lever handle opening	•
	Key opening	•

## Touch Type Panic Exit Device. Quick Series

### Rim model. QUICK20

Rim panic device with 2 locking points with steel roller bolts.  
 Used when a rim strike can not be installed in the lower locking point.

EN 1125 certification:

3 7 6 B 1 3 2 2 B A

The box includes:

- » 1 horizontal bar and a modular head.
- » Accessories: Fixing screws, 2 top and bottom strikes, follower and base plate.
- » 2 vertical rod devices (L=1090mm).
- » 2 vertical points (upper and lower).
- » Assembly instructions and installation template.



side view

QUICK20908GG

Model	Door width	Follower	Cover finish	Bar finish
QUICK20	900	8	Silver	Silver

### Configuration

1 leaf door

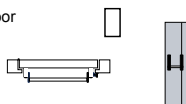

2 leaf door

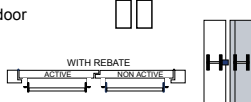

2 leaf door

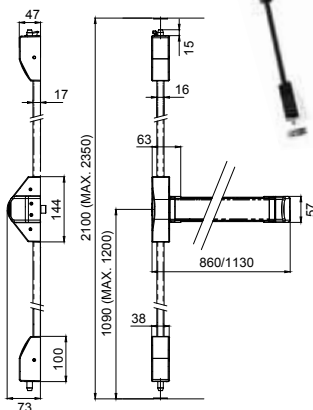
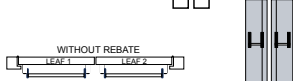

Outside device	Blind plate	Blind lever handle	Modular lever handle
No outside opening	•		
Free passing door		•	•
Cylinder locking	Knob / lever handle opening		•
	Captive Key system		• (1)

(1) It is needed to lock the outside access device to remove the key

# PANIC EXIT DEVICES

## Outside devices. Rim models



S1912EXNE

Adjustable cylinder  
available with 1910 systems.

### Sena lever handle

Outside device	Code No.
Sena Lever handle + euro-profile* black RAL 9005	S1912EXNE

### Adjustable cylinder

L	A	B	Code No.	Finish
40	30	10	TE5R3010L	Brass

### Lever handle + key

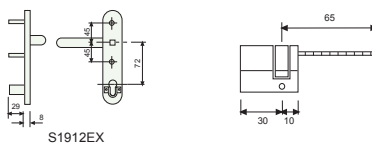

MMPS2T5NE

30 x 10 cylinder with  
r=15 mm available  
with 1910 X 1920 systems.

### Modular lever handle

Outside device	Cylinder	Product code
Modular lever handle with euro-profile black RAL 9005	TE-5	MMPS2T5NE

### Half cylinder

L	A	B	Code No.	Finish
40	30	10	5030301L	Brass

### Lever handle + key

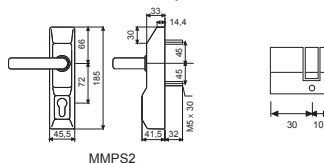

## Touch Type Exit Panic Devices



## 290 Park Avenue

### Feature:

Handles sets, made up of inside knob and mortise deadbolt, are particularly suited for outside doors of shops and homes, where elegance and security are paramount.

### Application:

Auxiliary and primary locking for residential and commercial buildings.

### Keying:

T80 security cylinder with 3 nickel silver keys.

### Knob Latch:

- Standard backsets: 60mm.

### Deadbolt Latch:

- Saw resistant.  
 - Adjustable backsets: 60 or 70mm

### Accessories:

Instructions, mounting template, strike plates and fixing screws included.

### Materials:

Die-cast pull handle.

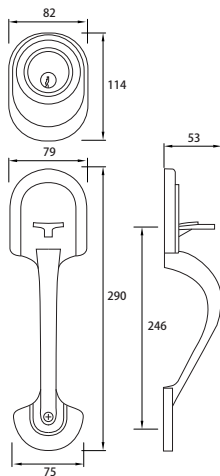

TE 290-6V-LP



TE 290-6V-LA

TE 290-6V-NS



## 2900 Bola

### Application:

- Residential single and multi-family door.

### Certification:

- Ansi grade 2 (400,000 cycles tests).

### Exposed trim:

- Wrought brass or bronze

### Keying:

- T80 security cylinder with 3 nickel silver keys.

### Backset:

- 2 $\frac{3}{8}$ " (60mm) backset. Anti thrust security pin spring latch prevent from thrusting the latch with a card or similar.

### Door Range:

- 33mm - 52mm standard.

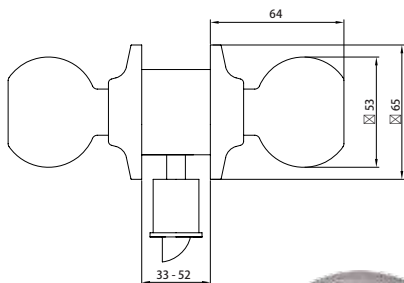

TE 2910-6V-LP



TE 2910-6V-LA

### Entrance Lock:

- Both side are locked and unlocked by outside key or inside turn-button.



TE 2910-6V-CM

## 2900 Bola

### Application:

- Residential single and multi-family door.

### Certification:

- Ansi grade 2 (400,000 cycles tests).

### Exposed trim:

- Wrought brass or bronze

### Backset:

- 2 $\frac{3}{8}$ " (60mm) backset.

### Door Range:

- 33mm - 52mm standard.

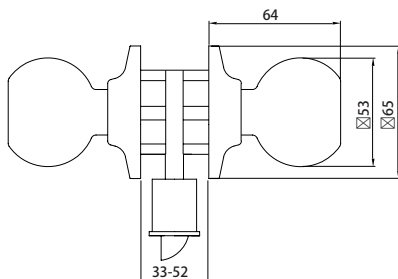

TE 2903-6V-LP



TE 2903-6V-LA

### Privacy Lock:

Both side are locked and unlocked by the inside turn-button. Emergency release outside.



TE 2903-6V-CM

## 2900 Bola

**Application:**

- Residential single and multi-family door.

**Certification:**

- Ansi grade 2 (400,000 cycles tests).

**Exposed trim:**

- Wrought brass or bronze

**Backset:**

- 2 $\frac{3}{8}$ " (60mm) backset.

**Door Range:**

- 33mm - 52mm standard.

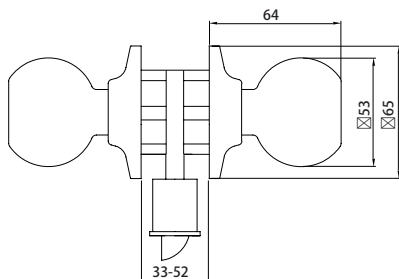

TE 2905-6V-LP



TE 2905-6V-LA

**Passage Lock:**

Both side always  
unlocked.



TE 2905-6V-CM

## 514

**Application:**

- Residential single and multi-family door.

**Certification:**

- Ansi grade 3 (200,000 cycles tests).

**Exposed trim:**

- Wrought brass or bronze

**Backset:**

- Universal standard fits either 2 $\frac{3}{8}$ " (60mm) or 2 $\frac{1}{4}$ " (70mm) backset. Saw resistant latch bolt.

**Door Range:**

- 33mm - 47mm standard.



TE 514-6V-NS



TE 514-6V-LP



TE 514-6V-LA

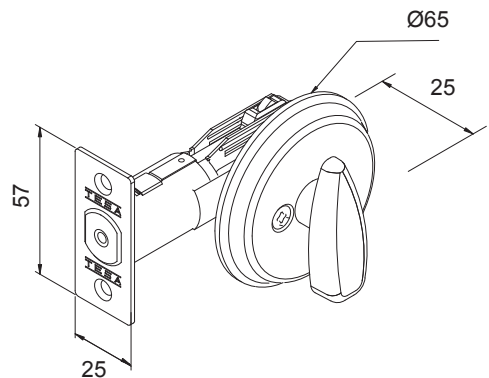

# DEADBOLT

## 516

**Application:**

- Residential single and multi-family door.

**Certification:**

- Ansi grade 3 (200,000 cycles tests).

**Exposed trim:**

- Wrought brass or bronze

**Keying:**

- T80 security cylinder with 3 nickel silver keys.

**Backset:**

- Universal standard fits either 2 $\frac{3}{4}$ " (60mm) or 2 $\frac{3}{4}$ " (70mm) backset. Saw resistant latch bolt.

**Door Range:**

- 33mm - 52mm standard.



TE 516-6V-NS



TE 516-6V-LP



TE 516-6V-LA

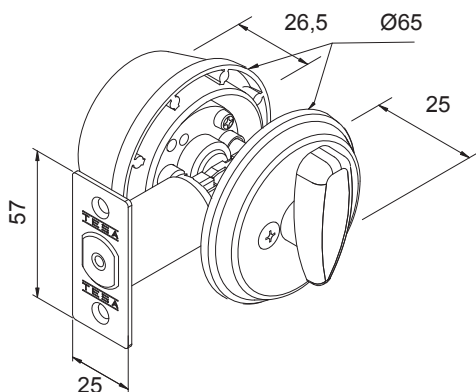

## 517

**Application:**

- Residential single and multi-family door.

**Certification:**

- Ansi grade 3 (200,000 cycles tests).

**Exposed trim:**

- Wrought brass or bronze

**Keying:**

- T80 security cylinder with 3 nickel silver keys.

**Backset:**

- Universal standard fits either 2 $\frac{3}{8}$ " (60mm) or 2 $\frac{3}{4}$ " (70mm) backset. Saw resistant latch bolt.

**Door Range:**

- 33mm - 52mm standard.



TE 517-6V-NS



TE 517-6V-LP



TE 517-6V-LA

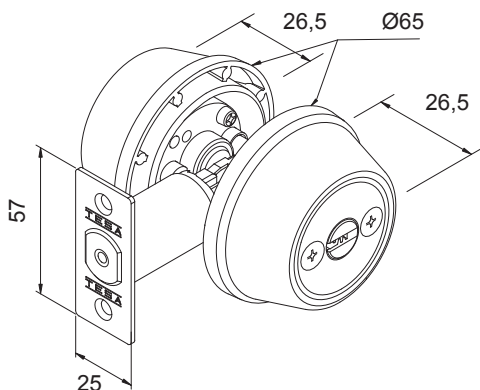

## Internal security

Still using a padlock with a flat key? The external appearance of a padlock is often considered to be more important than what is concealed within. That is why, although many padlocks have a robust external appearance, nobody had thought of using one of the best safety weapons existing for the inside: cylinders for flat keys! TESA has done this and provides you with padlocks which are as secure on the outside as on the inside.



## Masterkeying

Masterkeying enables the same key to be used in different padlocks, irrespective of the fact that each of them has its own key. Thus, maximum comfort and safety is obtained, because a single master key is capable of opening all the padlocks you wish. For offices, houses and companies of different sizes, masterkeying enables you to increase security by reducing the number of keys to be used, and to establish access control.



## TESA guarantees

Quality is assured when you buy TESA products. Here at TESA the very latest technology is used by a creative workforce organised within a management framework which has obtained not only the ISO9001 quality control guarantee but also the environmental certificate ISO 14001 and which delivers an on-going commitment to the very highest of health and safety standards at work.

## Interchangeability

The only padlock in the world which is adapted to your needs. Depending on your security needs or on the goods you wish to protect, our padlocks give you the chance to choose the cylinder you prefer for your padlock and to change it when you wish. In this way you choose the degree of security desired at any given time, because we give you the chance to choose from among the wide range of TESA cylinders.



## Electronic cylinders for access control

Access points which nobody believed could be controlled now under control. The possibility of exchanging cylinders gives a new dimension to padlocks: the chance to insert an electronic cylinder for access control in your padlock and therefore to know who has entered this access point, when and at what exact time. In this way, you can choose to integrate any access point within a comprehensive locking plan, even though the only way of locking it may be by using a padlock. Thus, you will not leave a single access point outside the security system you design.



## Changeable brass series

- Equipment with TESA cylinder system.
- Double security locking mechanism.
- Hardened steel shackle.
- Varnished brass casing for better protection.
- Possibility of keys alike and masterkeying.
- Stainless steel springs.

Code No.	Packaging	A	B	C	D	U/Price
CL55SCIL	In box	55	94	34	9	218.00
CL55T60LT	In box	55	94	34	9	343.00
CL55T80LT	In box	55	94	34	9	468.00

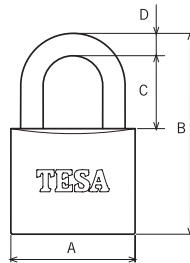

CL55SCIL

## Titanium series

- High security padlock.
- High resistance double security ball locking mechanism.
- All types of masterkeying.
- Hardened chrome steel casing and shackle.
- Hytel protective covering.
- Cylinder protection system.
- Non-removable key with open padlock.
- Anti-guillotine, anti-lever model CT60APCR model and anti-extraction.
- Maximum security reversible key cylinders.

Code No.	Packaging	A	B	C	D	U/Price
CT60T60CR	In box	60	93	23	11	718.00
CT60T80CR	In box	60	93	23	11	780.00

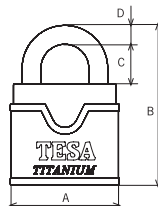

## Titanium series, protected shackle

Code No.	Packaging	A	B	C	D	U/Price
CT60APT60CR	In box	60	93	23	11	827.00
CT60APT80CR	In box	60	93	23	11	889.00

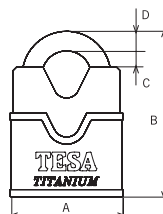



## Different Types of Master key systems

A master key system is a planned locking system where a master key can open more than one cylinder, even if each cylinder has its own key. For offices, residential homes and blocks of various floors, the master key system is the immediate solution that allows to establish an access control while reducing the number of keys that must be handled: security and comfort.

**Central locking system.**  
(Community type).

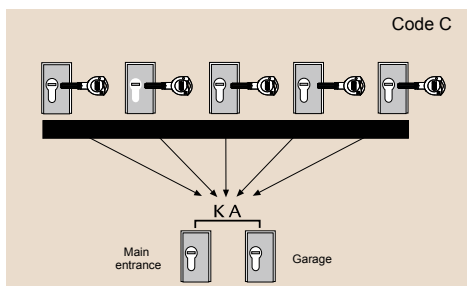

**Central locking system with master key.**  
(Company type)

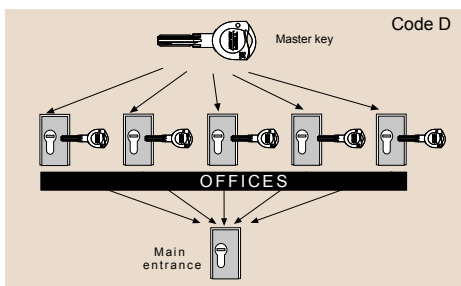

**Central locking with several levels.**  
(Apartment blocks type.)

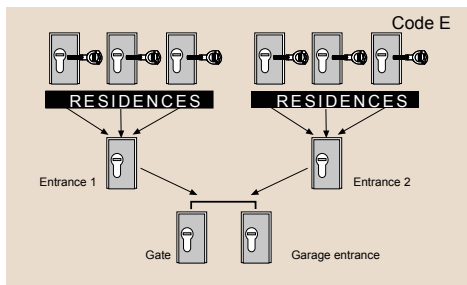

**Simple master key suite.**

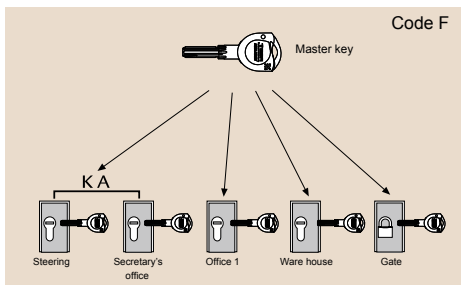

**Group master key suite.**  
(Hotel type)

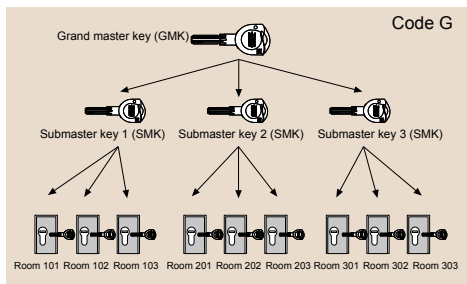

**Complex master key system**  
(Company type)

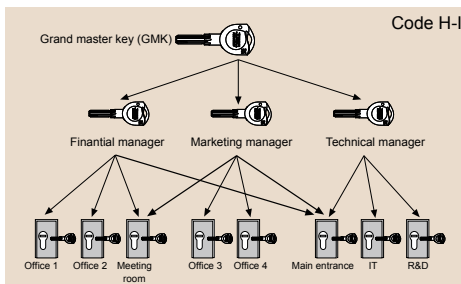

## Key blank

System	Material	Code No.	U/Price
TE5	Steel	LLAVTE5HH	
T50	Brass nickel plated	LLAT50TESALN	
T60	Brass nickel plated	LLAVBRT60NS	
T80	Nickel silver.	LLAVBRT80	
T10	Nickel silver.	LLAVBRT1	
T12	Nickel silver.	LLAVBRT12TESA	
TK6	Nickel silver.	LLATK6K62ART	



## Combi RFID key

The RFID COMBI key from TESA allows mechanical master key systems to be compatible with TESA Standalone or other access control systems in only one device or credential.

COMBI key can be compatible with mechanical T80 cylinders, furthermore, user will also have access to RFID MIFARE technology electronic lock or wall readers simply approaching the key head.

System	Code No. (cut key)	Code No. (blank key)
T80	LLAT80TALLCOMBI	LLAVBRT80COMBI

